

GENERAL LEGEND

- OPEN STREETS & SECTION LINE ROADS
 - RAILROADS
 - RAILWAY CROSSING
 - RAILWAY STATION
 - COUNTY MAJOR COLLECTOR CMC
 - INTERSTATE NUMBERED HIGHWAY
 - U.S. NUMBERED HIGHWAY
 - STATE HIGHWAY
 - CORPORATE BOUNDARY
-
- CROSSING TYPE
- AUTOMATIC FLASHING **Y012**
 - CROSS BUCKS **Y016**
 - AUTOMATIC FLASHING WITH GATES **Y018**

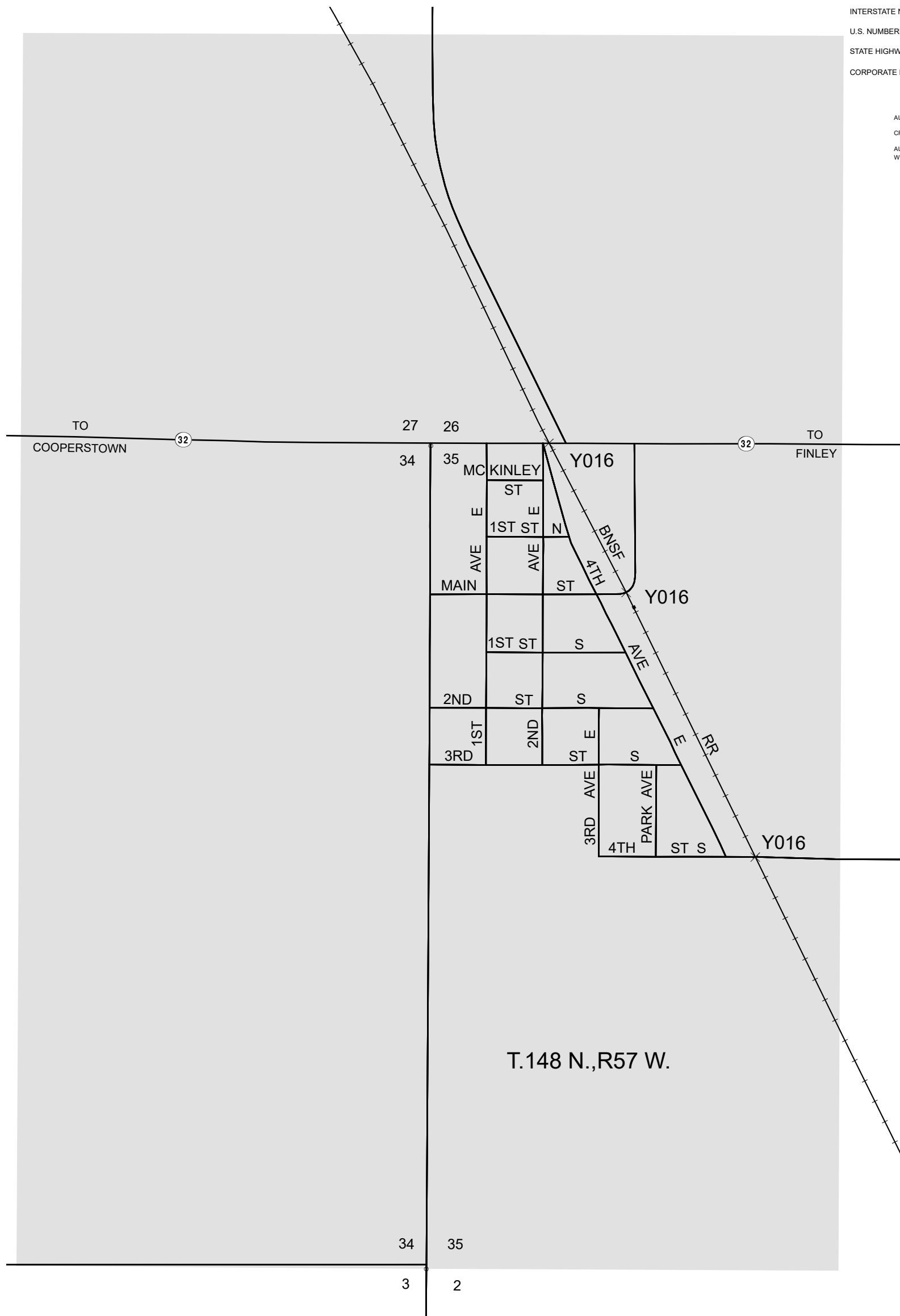

2020 Population 86
SHARON
 STEELE COUNTY
 NORTH DAKOTA

PREPARED BY
 NORTH DAKOTA DEPARTMENT OF TRANSPORTATION
 PLANNING / ASSET MANAGEMENT DIVISION
 IN COOPERATION WITH THE
 U.S. DEPARTMENT OF TRANSPORTATION
 FEDERAL HIGHWAY ADMINISTRATION

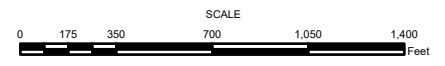

2020

Notice of Disclaimer
 The North Dakota Department of Transportation (NDDOT) makes this map available on an "as is" basis as a public service. Under no circumstances does NDDOT warrant or certify the information to be free of errors or deficiencies of any kind. NDDOT specifically disclaims all warranties, express or implied, including but not limited to the warranties of merchantability and fitness for a particular purpose.