

NAME AND LOCATION OF ORGANIZED CIVIL TOWNSHIPS THOSE UNORGANIZED ARE SO NOTED

- | | |
|------------------------------------|-----------------------------------|
| T. 144 N. - R. 79 W. WILSON | T. 140 N. - R. 80 W. UNORGANIZED |
| T. 144 N. - R. 78 W. STEIBER | T. 140 N. - R. 79 W. NAUGHTON |
| T. 144 N. - R. 77 W. SCHRUNK | T. 140 N. - R. 78 W. FRANCES |
| T. 144 N. - R. 76 W. FLORENCE LAKE | T. 140 N. - R. 77 W. SIBLEY BUTTE |
| T. 144 N. - R. 75 W. HAZEL GROVE | T. 140 N. - R. 76 W. CHRISTIANA |
| T. 143 N. - R. 79 W. GRASS LAKE | T. 140 N. - R. 75 W. CLEAR LAKE |
| T. 143 N. - R. 78 W. ESTHERVILLE | T. 139 N. - R. 81 W. HAY CREEK |
| T. 143 N. - R. 77 W. CANFIELD | T. 139 N. - R. 80 W. HAY CREEK |
| T. 143 N. - R. 76 W. RICHMOND | T. 139 N. - R. 79 W. GIBBS |
| T. 143 N. - R. 75 W. RICHMOND | T. 139 N. - R. 78 W. MENOKEN |
| T. 142 N. - R. 81 W. PAINTED WOODS | T. 139 N. - R. 77 W. MCKENZIE |
| T. 142 N. - R. 80 W. PAINTED WOODS | T. 139 N. - R. 76 W. STERLING |
| T. 142 N. - R. 79 W. ECKLUND | T. 139 N. - R. 75 W. DRISCOLL |
| T. 142 N. - R. 78 W. WING | T. 138 N. - R. 80 W. UNORGANIZED |
| T. 142 N. - R. 77 W. ROCK HILL | T. 138 N. - R. 79 W. APPLE CREEK |
| T. 142 N. - R. 76 W. WING | T. 138 N. - R. 78 W. BOYD |
| T. 142 N. - R. 75 W. HARRIETT | T. 138 N. - R. 77 W. LOGAN |
| T. 141 N. - R. 81 W. GLENVIEW | T. 138 N. - R. 76 W. TAFT |
| T. 141 N. - R. 80 W. GLENVIEW | T. 138 N. - R. 75 W. THELMA |
| T. 141 N. - R. 79 W. CLOFTE | T. 137 N. - R. 80 W. UNORGANIZED |
| T. 141 N. - R. 78 W. CROWWELL | T. 137 N. - R. 79 W. MISSOURI |
| T. 141 N. - R. 77 W. TRYGG | T. 137 N. - R. 78 W. TELFER |
| T. 141 N. - R. 76 W. UNORGANIZED | T. 137 N. - R. 77 W. MORTON |
| T. 141 N. - R. 75 W. LEIN | T. 137 N. - R. 76 W. LONG LAKE |
| T. 140 N. - R. 81 W. UNORGANIZED | T. 137 N. - R. 75 W. WILD ROSE |

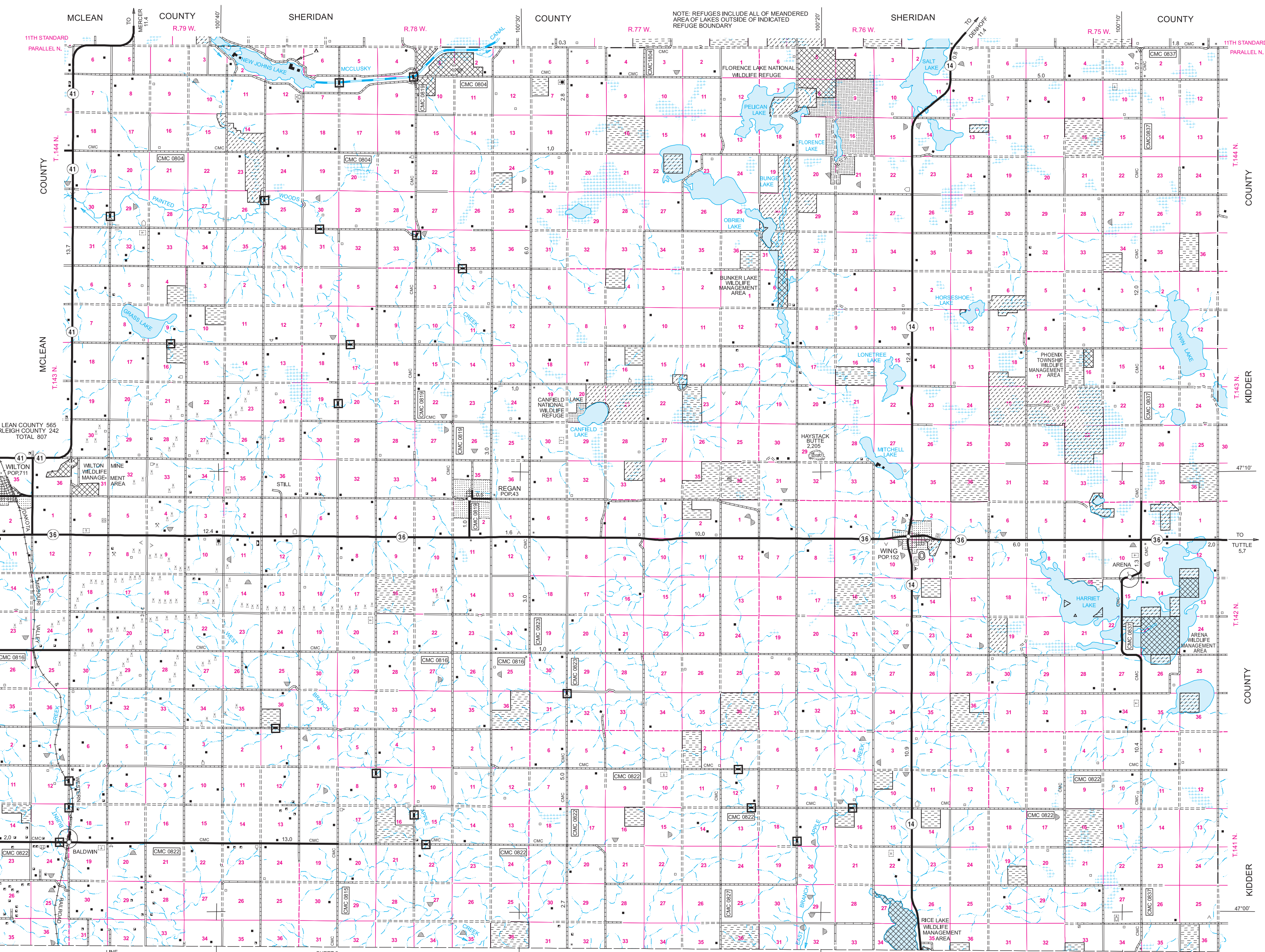
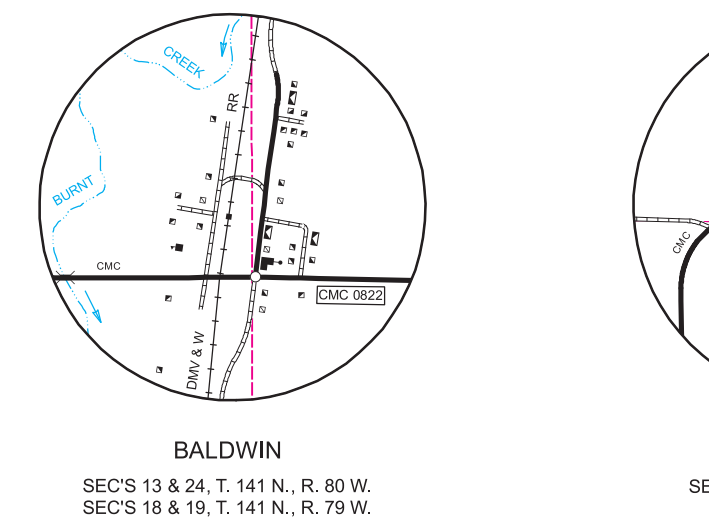
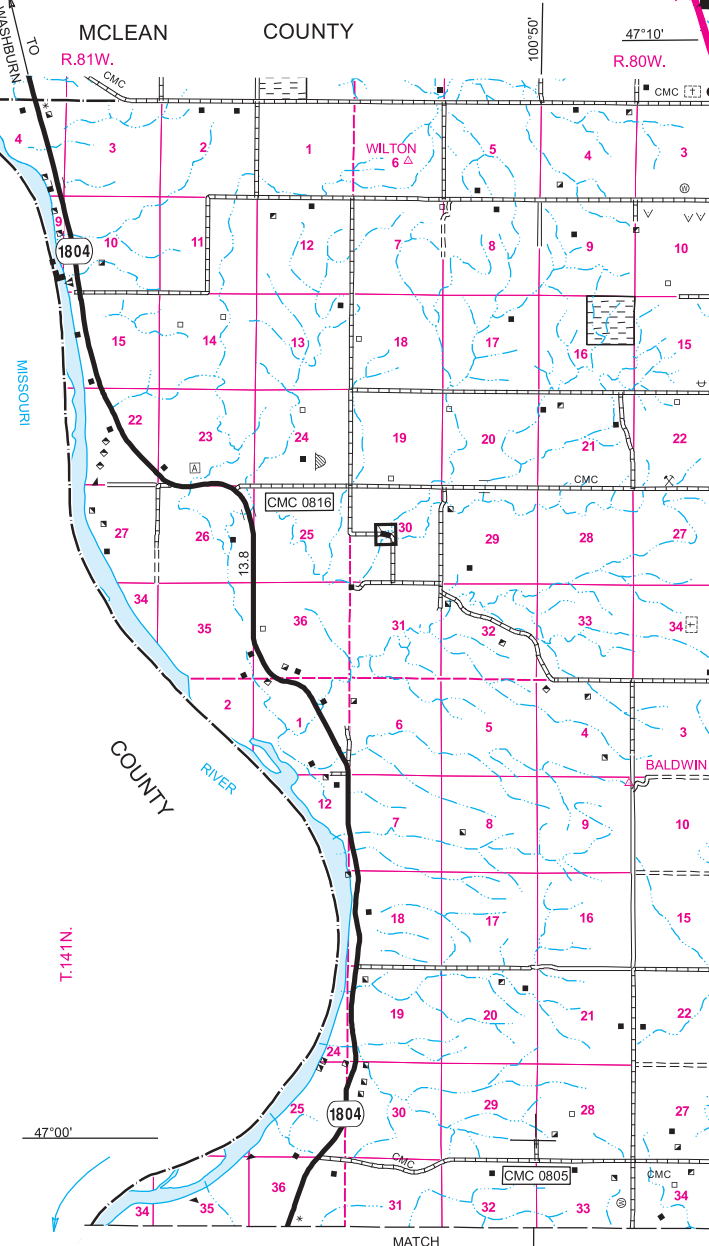

GENERAL LEGEND

ROADS AND ROADWAY FEATURES	PUBLIC SERVICE FACILITIES
PRIMITIVE ROAD	HIGHWAY GARAGE
UNIMPROVED ROAD	FIRE ENGINE HOUSE
GRAVEL AND DRAINED ROAD	GARBAGE OR RUBBISH DUMP
PAVED ROAD	SEWAGE DISPOSAL PLANT
STREETS IN UNINCORPORATED AREAS	AUTOMOBILE GRAVEYARD
INTERCHANGE	WATER SUPPLY STAND PIPE OR TANK
INDIAN SERVICE ROAD	POWER SUBSTATION
COUNTY MAJOR COLLECTOR	BOOSTER STATION
ROUTE NUMBER	BROADCASTING STATION (RADIO OR TV)
POINTS BETWEEN WHICH DISTANCES ARE MEASURED	COMMUNICATION TOWER
INTERSTATE NUMBERED HIGHWAY	MUNICIPAL BUILDING
U.S. NUMBERED HIGHWAY	WEATHER OBSERVATION STATION
STATE HIGHWAY SYSTEM	
BOUNDARIES	CONSERVATION AND RECREATION
COUNTY LINE	PICNIC GROUND
TOWNSHIP LINE	PLAYGROUND, BALL FIELD, ETC.
CORPORATE LINE	BATHING BEACH OR SWIMMING POOL
SECTION LINE	TOURIST COURT, OR MOTEL
MATCH LINE BETWEEN ADJOINING SHEETS OF SAME COUNTY	CAMP OR LODGE
BOUNDARY TO MARK ENLARGEMENT INSET	(PERMANENT SITE WITH BUILDINGS)
NATIONAL REFUGES	REST AREA
MONUMENT - SMALL HISTORIC SITE	SMALL PARK (SP-STATE, CP-COUNTY, MP-MUNICIPAL, WP-WAYSIDE PARK)
WILDLIFE MANAGEMENT AREA	GOLF GROUND OR COUNTRY CLUB
WATERFOWL PRODUCTION AREA	AMUSEMENT PARK OR HALL
STATE PARKS	FAIR GROUND, RACE COURSE, SPEEDWAY
STATE SCHOOL LAND	ARCHERY CLUB
RESERVOIR BOUNDARY (TAKING LINE)	RIFLE CLUB
	RIDING ACADEMY
	MARINA
	ZOO
NATURAL FEATURES	FARM UNITS, DWELLINGS, ETC.
PROMINENT ELEVATION - WITH NAME	FARM UNIT (FARM UNITS SHOWN IN MUNICIPAL LIMITS INDICATE FARM BUILDINGS FOR FARM USE)
RAILROADS	DWELLING OTHER THAN FARM
RAILROAD (ANY NUMBER OF TRACKS USED BY A SINGLE OPERATING CO.)	ROWS OR GROUPS OF DWELLINGS
RAILROAD STATION	CLOSELY SPACED (FIGURE DENOTES NUMBER OF DWELLINGS)
RAILROAD GRADE CROSSING	BARNS, OR DORMATORIES FOR STUDENTS, WORKERS, MIGRANTS, ETC.
RAILROAD ABOVE	SEASONAL OR SUMMER COLONY
RAILROAD BELOW	DWELLING
	CHURCH
	CEMETERY
	CHURCH WITH CEMETERY ADJACENT
	TENANT HOUSE
CITY AND VILLAGE CENTERS	STRUCTURES
STATE CAPITAL	HIGHWAY BRIDGE, GENERAL
COUNTY SEAT	HIGHWAY GRADE SEPARATION
OTHER CITIES AND VILLAGES	DAM WITH ROAD
INCORPORATED CITY OR VILLAGE (GENERALIZED)	MINOR DRAINAGE STRUCTURE
	FORD - ROAD ESTABLISHED
	TRUSS OR GIRDER
DRAINAGE	INDUSTRIAL
INTERMITTENT STREAM (NARROW)	FACTORY OR INDUSTRIAL PLANT
NARROW STREAM	GROUP OF STORAGE TANKS (OIL OR GAS)
WIDE STREAM	FILLING STATION
WIDE STREAM WITH DAM	PUMPING STATION (OIL OR GAS)
LAKE, RESERVOIR, OR POND	WAREHOUSE - GENERAL
LAKE, RESERVOIR, OR POND WITH DAM	GRAIN ELEVATOR
MARSH OR SWAMP LAND	STOCK YARD - LOADING PEN OR CORRAL
CANAL	GRAVEL PIT
	GREENHOUSE
	MINE - SHAFT OR DRIFT (ANY KIND)
	NURSERY
	WIND TURBINE
	AIRPORTS
	AIRPORT, COMPLETE FACILITIES
	LANDING AREA OR STRIP
	AIRWAY LIGHT BEACON, GENERAL

**GENERAL HIGHWAY MAP
BURLEIGH COUNTY
NORTH DAKOTA**

PREPARED BY THE
NORTH DAKOTA DEPARTMENT OF TRANSPORTATION
PLANNING / ASSET MANAGEMENT DIVISION
IN COOPERATION WITH THE
U.S. DEPARTMENT OF TRANSPORTATION
FEDERAL HIGHWAY ADMINISTRATION

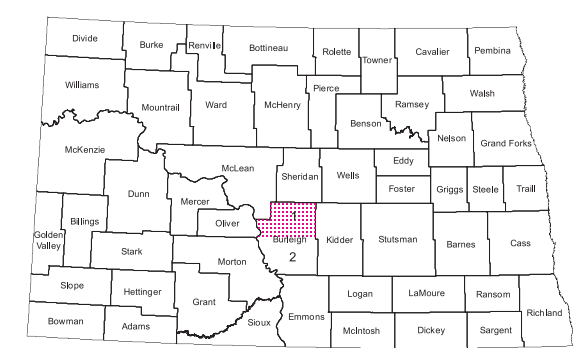
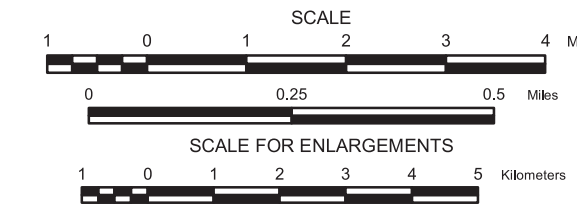
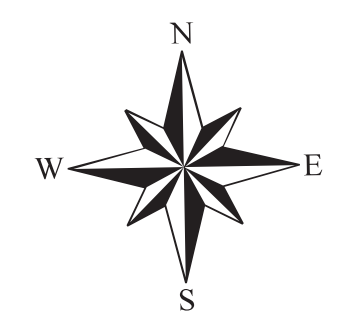

STATE OF NORTH DAKOTA
DIAGRAM OF COUNTIES

2013

BASED ON AERIAL PHOTOGRAPHY OF 1957
GROUND INVENTORY OF 2013
AERIAL INVENTORY OF 2013
UNIVERSAL TRANSVERSE MERCATOR ZONE 14
NORTH AMERICAN DATUM 83

Notice of Disclaimer
The North Dakota Department of Transportation (NDDOT) makes this map available on an "as is" basis as a public service. Under no circumstances does NDDOT warrant or certify the information to be free of errors or deficiencies of any kind. NDDOT specifically disclaims all warranties, express or implied, including but not limited to the warranties of merchantability and fitness for a particular purpose.

COPIES OF THIS MAP ARE AVAILABLE FOR PUBLIC USE AT A NOMINAL COST FROM:
MAP SALES, N.D. DEPT. OF TRANSPORTATION, 608 E. BLVD. AVE., BISMARCK, N.D. 58505-0700