

GENERAL LEGEND

ROADS AND ROADWAY FEATURES	FARM UNITS, DWELLINGS, ETC.
PRIMITIVE ROAD	FARM UNIT (FARM UNITS SHOWN IN MUNICIPAL LIMITS INDICATE FARM BUILDINGS FOR FARM USE)
UNIMPROVED ROAD	DWELLING OTHER THAN FARM
GRADED AND DRAINED ROAD	ROWS OR GROUPS OF DWELLINGS
GRAVEL GRADED AND DRAINED ROAD	CLOSELY SPACED (FIGURE DENOTES NUMBER OF DWELLINGS)
PAVED ROAD	SEASONAL OR SUMMER COLONY
STREETS IN UNINCORPORATED AREAS	DWELLING
COUNTY MAJOR COLLECTOR	CEMETERY
ROUTE NUMBER	CHURCH WITH CEMETERY ADJACENT
POINTS BETWEEN WHICH DISTANCES ARE MEASURED	WELL
INTERSTATE NUMBERED HIGHWAY	INDUSTRIAL
U.S. NUMBERED HIGHWAY	STORE OR SMALL BUSINESS ESTABLISHMENT
STATE HIGHWAY SYSTEM	FACTORY OR INDUSTRIAL PLANT
STRUCTURES	GROUP OF STORAGE TANKS (OIL OR GAS)
HIGHWAY BRIDGE, GENERAL	Gauging or Pumping Station
MINOR DRAINAGE STRUCTURE	WAREHOUSE - GENERAL
FORD - ROAD ESTABLISHED	GRAIN ELEVATOR
RAILROADS	STOCK YARD - LOADING PEN OR CORRAL
RAILROAD (ANY NUMBER OF TRACKS USED BY A SINGLE OPERATING CO.)	GRAVEL PIT
RAILROAD STATION	NURSERY
RAILROAD ABOVE	EDUCATIONAL AND CORRECTIONAL INSTITUTIONS
CITY AND VILLAGE CENTERS	COUNTY SEAT
COUNTY SEAT	OTHER CITIES AND VILLAGES
INCORPORATED CITY OR VILLAGE (GENERALIZED)	INCORPORATED CITY OR VILLAGE (GENERALIZED)
DRAINAGE	AGRICULTURAL EXPERIMENT STATION
INTERMITTENT STREAM (NARROW)	CONSERVATION AND RECREATION
NARROW STREAM	PICNIC GROUND
WIDE STREAM	PLAYGROUND, BALL FIELD, ETC.
WIDE STREAM WITH DAM	CAMP SITE, NO PERMANENCE (TENTS OR TRAILER PARKING)
LAKE, RESERVOIR, OR POND	GOLF GROUND OR COUNTRY CLUB
LAKE, RESERVOIR, OR POND WITH DAM	AMUSEMENT PARK OR HALL
MARSH OR SWAMP LAND	PUBLIC SERVICE FACILITIES
NAVIGATION	HIGHWAY GARAGE
DOCK, PIER, OR LANDING	GARBAGE OR RUBBISH DUMP
BOUNDARIES	SEWAGE DISPOSAL PLANT
COUNTY LINE	SANITARY FILL
TOWNSHIP LINE	AUTOMOBILE GRAVEYARD
CORPORATE LINE	POWER SUBSTATION
SECTION LINE	COMMUNICATION TOWER
BOUNDARY TO MARK ENLARGEMENT INSET	MUNICIPAL BUILDING
NATIONAL REFUGES	MISCELLANEOUS
MONUMENT - SMALL, HISTORIC SITE	TRIANGULATION STATION
WILDLIFE MANAGEMENT AREA	FORT, ARMY CAMP, BARRACKS, OR OTHER MILITARY POST
WATERFOWL PRODUCTION AREA	DOT TO INDICATE LOCATION OF ANY CULTURAL FEATURE SHOWN OUT OF POSITION
STATE SCHOOL LAND	ALL VACANT CULTURE INDICATED BY OPEN SYMBOL
AIRPORTS	LATITUDE AND LONGITUDE
AIRPORT, GENERAL	
AIRFIELD, LIMITED FACILITIES	
LANDING AREA OR STRIP	

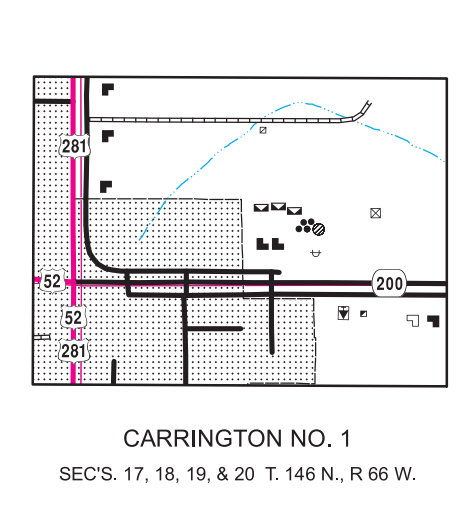
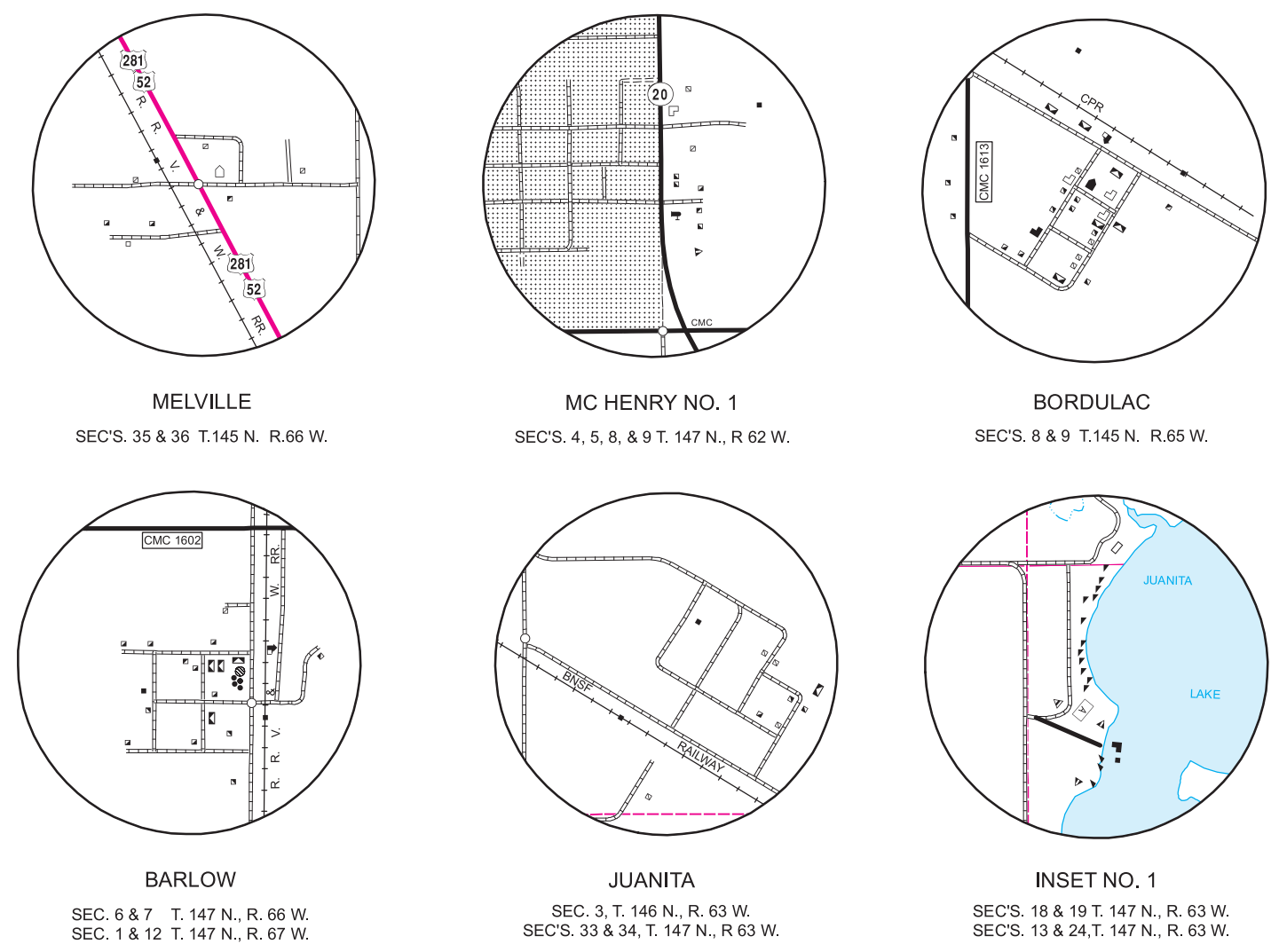

NAME AND LOCATION OF ORGANIZED CIVIL TOWNSHIPS THOSE UNORGANIZED ARE SO NOTED

T. 147 N.-R. 67 W. BIRTSSELL
 T. 147 N.-R. 66 W. ESTABROOK
 T. 147 N.-R. 65 W. NORDMORE
 T. 147 N.-R. 64 W. LARRABEE
 T. 147 N.-R. 63 W. FLORANCE
 T. 147 N.-R. 62 W. MC HENRY
 T. 146 N.-R. 67 W. WYARD
 T. 146 N.-R. 66 W. CARRINGTON
 T. 146 N.-R. 65 W. ROSE HILL
 T. 146 N.-R. 64 W. HAVEN
 T. 146 N.-R. 63 W. ROLLING PRAIRIE
 T. 146 N.-R. 62 W. LONGVIEW
 T. 145 N.-R. 66 W. MELVILLE
 T. 145 N.-R. 65 W. BORDULAC
 T. 145 N.-R. 64 W. SUCCEPHALIA
 T. 145 N.-R. 63 W. MC KINNON
 T. 145 N.-R. 62 W. EASTMAN

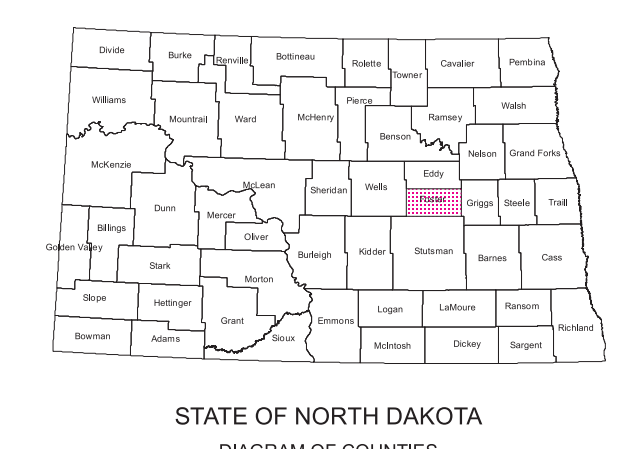

Notice of Disclaimer
 The North Dakota Department of Transportation (NDDOT) makes this map available on an "as is" basis as a public service. Under no circumstances does NDDOT warrant or certify the information to be free of errors or deficiencies of any kind. NDDOT specifically disclaims all warranties, express or implied, including but not limited to the warranties of merchantability and fitness for a particular purpose.
 COPIES OF THIS MAP ARE AVAILABLE FOR PUBLIC USE AT A NOMINAL COST FROM:
 MAP SALES, N.D. DEPT. OF TRANSPORTATION, 608 E. BLVD. AVE., BISMARCK, ND 58505-0700

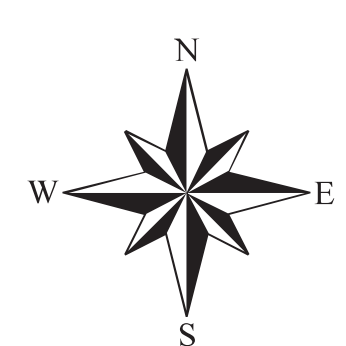

GENERAL HIGHWAY MAP
FOSTER COUNTY
NORTH DAKOTA

PREPARED BY THE
 NORTH DAKOTA DEPARTMENT OF TRANSPORTATION
 PLANNING / ASSET MANAGEMENT DIVISION
 IN COOPERATION WITH THE
 U.S. DEPARTMENT OF TRANSPORTATION
 FEDERAL HIGHWAY ADMINISTRATION

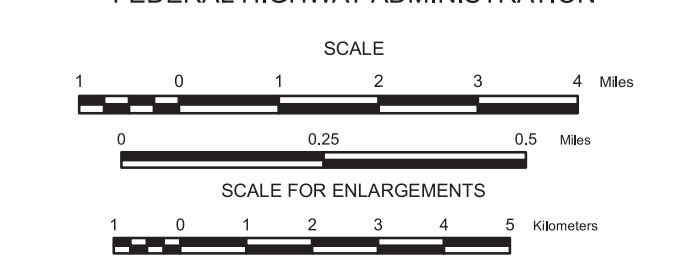

2016

BASED ON AERIAL PHOTOGRAPHY OF 1954
 AERIAL INVENTORY OF 2016
 UNIVERSAL TRANSVERSE MERCATOR ZONE 14
 NORTH AMERICAN DATUM 83
 GENERAL HIGHWAY MAP **FOSTER COUNTY** NORTH DAKOTA 16-1
 SHEET 1 OF 1