

GENERAL LEGEND

- ROADS AND ROADWAY FEATURES**
- PRIMITIVE ROAD
- UNIMPROVED ROAD
- GRADED AND DRAINED ROAD
- GRAVEL GRADED AND DRAINED ROAD
- PAVED ROAD
- STREETS IN UNINCORPORATED AREAS
- INTERCHANGE
- INDIAN SERVICE ROAD
- COUNTY MAJOR COLLECTOR
- ROUTE NUMBER
- POINTS BETWEEN WHICH DISTANCES ARE MEASURED
- INTERSTATE NUMBERED HIGHWAY
- U.S. NUMBERED HIGHWAY
- STATE HIGHWAY SYSTEM

- STRUCTURES**
- 4 LANE HIGHWAY BRIDGE
- HIGHWAY BRIDGE, GENERAL
- DAM WITH ROAD
- MINOR DRAINAGE STRUCTURE
- FORD - ROAD ESTABLISHED

- LEVEE OR DIKE

- AIRPORTS**
- AIRPORT, COMPLETE FACILITIES
- LANDING AREA OR STRIP
- MILITARY FIELD (SOME FACILITIES AVAILABLE)
- AIRPORT, GENERAL

- DRAINAGE**
- INTERMITTENT STREAM (NARROW)
- NARROW STREAM
- WIDE STREAM
- WIDE STREAM WITH DAM
- LAKE, RESERVOIR, OR POND
- LAKE, RESERVOIR, OR POND WITH DAM
- MARSH OR SWAMP LAND
- DRAINAGE DITCH
- IRRIGATION DITCH

- NAVIGATION**
- DOCK, PIER, OR LANDING

- BOUNDARIES**
- STATE OR PROVINCE LINE
- COUNTY LINE
- TOWNSHIP LINE
- CORPORATE LINE
- SECTION LINE
- MATCH LINE BETWEEN ADJOINING SHEETS OF SAME COUNTY
- BOUNDARY TO MARK ENLARGEMENT INSET
- NATIONAL PARKS AND OTHER RESERVATIONS
- MONUMENT - SMALL HISTORIC SITE
- WILDLIFE MANAGEMENT AREA
- WATERFOWL PRODUCTION AREA
- STATE PARKS
- STATE SCHOOL LAND

- MISCELLANEOUS**
- ARMORY
- TRIANGULATION STATION
- FORT, ARMY CAMP, BARRACKS, OR OTHER MILITARY POST
- DOT TO INDICATE LOCATION OF ANY CULTURAL FEATURE SHOWN OUT OF POSITION
- ALL VACANT CULTURE INDICATED BY OPEN SYMBOL
- LATITUDE AND LONGITUDE

- FARM UNITS, DWELLINGS, ETC.**
- FARM UNIT (FARM UNITS SHOWN IN MUNICIPAL LIMITS INDICATE FARM BUILDINGS FOR FARM USE)
- DWELLING OTHER THAN FARM
- ROWS OR GROUPS OF DWELLINGS CLOSELY SPACED (FIGURE DENOTES NUMBER OF DWELLINGS)
- BARRACKS, OR DORMATORIES FOR STUDENTS, WORKERS, IMMIGRANTS, ETC.
- SEASONAL OR SUMMER COLONY
- DWELLING
- SEASONAL DWELLINGS CLOSELY SPACED
- HOTEL OR INN
- CHURCH
- CEMETERY
- CHURCH WITH CEMETERY ADJACENT
- TOLL HOUSE, STATE PORT OF ENTRY, OR WEIGHT STATION
- TENANT HOUSE

- CITY AND VILLAGE CENTERS**
- OTHER CITIES AND VILLAGES
- INCORPORATED CITY OR VILLAGE (GENERALIZED)

- EDUCATIONAL AND CORRECTIONAL INSTITUTIONS**
- SCHOOLHOUSE
- TOWNHALL, GRANGE, OR COMMUNITY HALL

- CONSERVATION AND RECREATION**
- PICNIC GROUND
- PLAYGROUND, BALL FIELD, ETC.
- BATHING BEACH OR SWIMMING POOL
- CAMP SITE, NO PERMANENCE (TENTS OR TRAILER PARKING)
- TOURIST COURT, OR MOTEL
- REST AREA
- SMALL PARK (SP-STATE, CP-COUNTY, MP-MUNICIPAL, WP-WAYSIDE PARK)
- GOLF GROUND OR COUNTRY CLUB
- AMUSEMENT PARK OR HALL
- FAIR GROUND, RACE COURSE, SPEEDWAY
- RIDING ACADEMY
- DRIVE-IN THEATER

- PUBLIC SERVICE FACILITIES**
- POST OFFICE
- HIGHWAY GARAGE
- GARBAGE OR RUBBISH DUMP
- SEWAGE DISPOSAL PLANT
- AUTOMOBILE GRAVEYARD
- SCRAP BUILDING MATERIAL
- WATER SUPPLY STAND PIPE OR TANK
- POWER SUBSTATION
- BOOSTER STATION
- COMMUNICATION TOWER
- MUNICIPAL BUILDING
- U.S. BORDER CUSTOMS STATION

- INDUSTRIAL**
- STORE OR SMALL BUSINESS
- ESTABLISHMENT
- FACTORY OR INDUSTRIAL PLANT
- GROUP OF STORAGE TANKS (OIL OR GAS)
- GAUGING OR PUMPING STATION
- WAREHOUSE - GENERAL
- GRAIN ELEVATOR
- GRAVEL PIT
- OIL OR GAS WELL
- GREENHOUSE
- NURSERY

- RAILROADS**
- RAILROAD (ANY NUMBER OF TRACKS USED BY A SINGLE OPERATING CO.)
- RAILROAD STATION

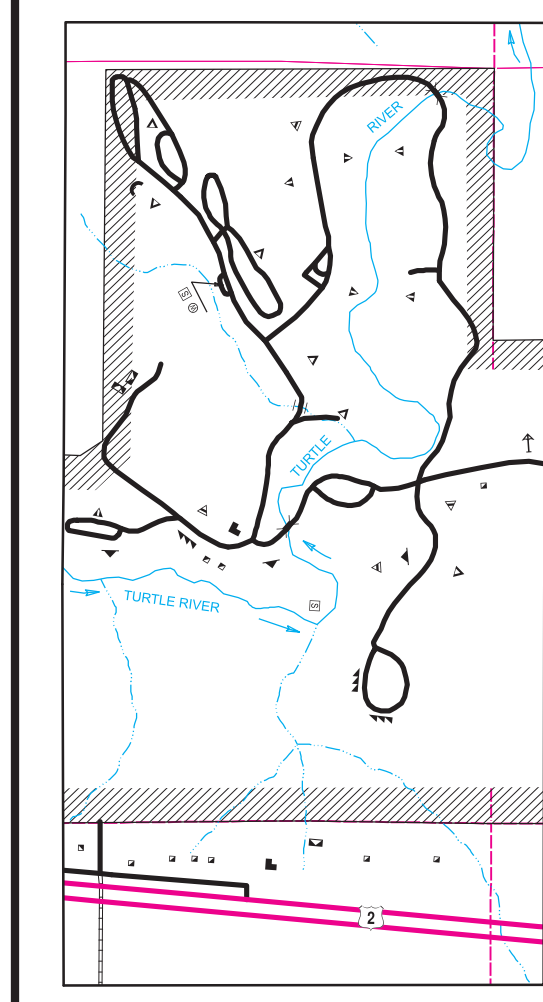

TURTLE RIVER STATE PARK
 SEC'S 30 & 31 T. 152 N., R. 53 W.
 SEC'S 25 & 26 T. 152 N., R. 54 W.
 SEC. 6, T. 151 N., R. 53 W.
 SEC. 1, T. 151 N., R. 54 W.

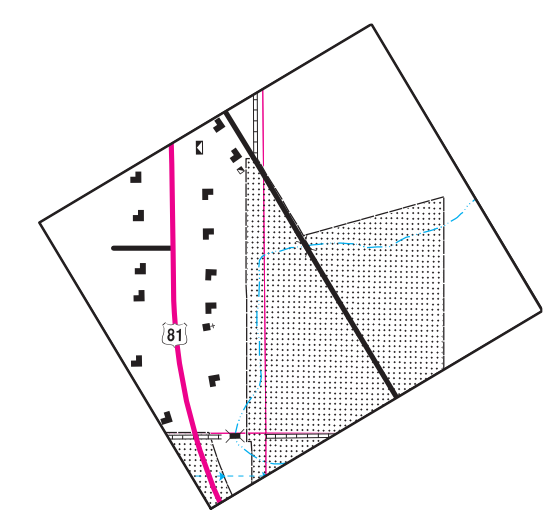

GRAND FORKS NO. 1
 SEC'S 28, 29, 32, & 33, T. 152 N., R. 50 W.

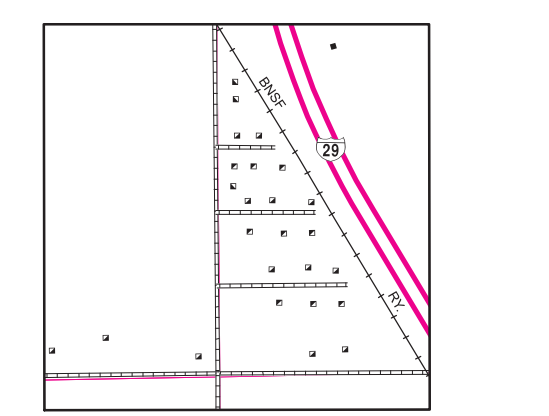

INSET NO. 3
 SEC'S 14, 15, 22, & 23, T. 153 N., R. 51 W.

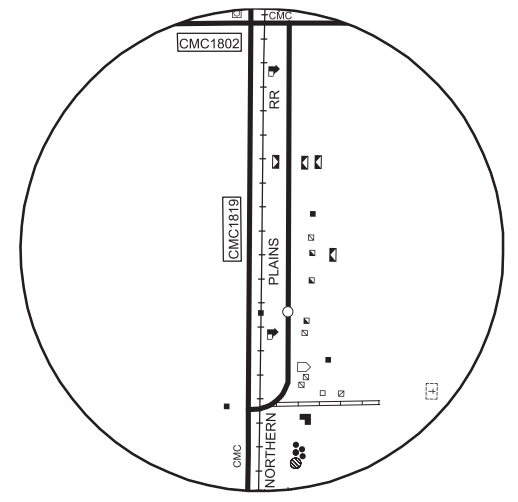

JOHNSTOWN
 SEC'S 16, 17, 20, & 21 T. 154 N., R. 53 W.

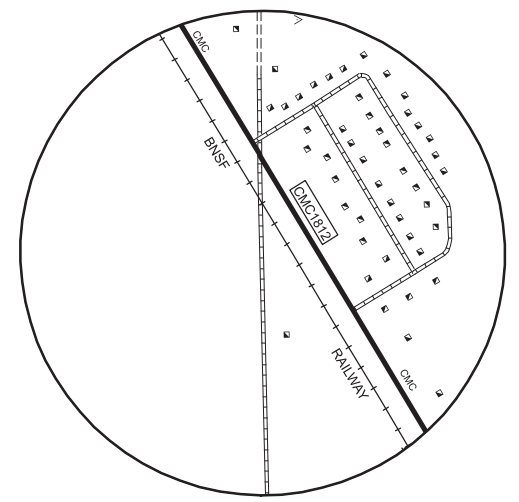

INSET NO. 2
 SEC. 12, T. 152 N., R. 51 W.
 SEC. 7, T. 152 N., R. 50 W.

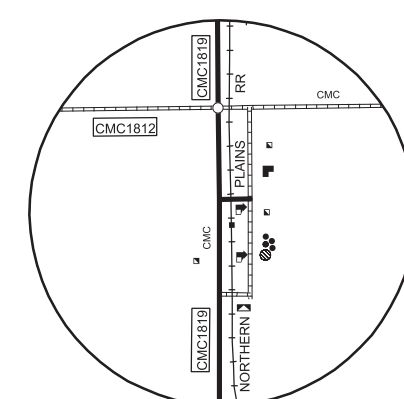

HONEYFORD
 SEC'S 28, 29, 32, & 33, T. 153 N., R. 53 W.

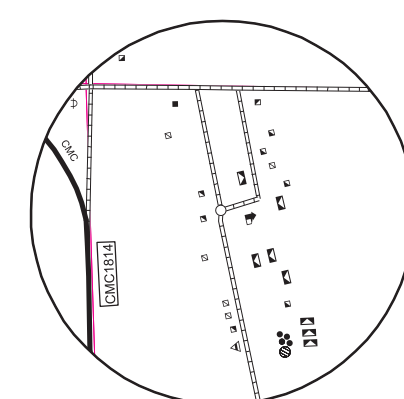

MC CANNA
 SEC'S 4, 5, 8, & 9 T. 152 N., R. 55 W.

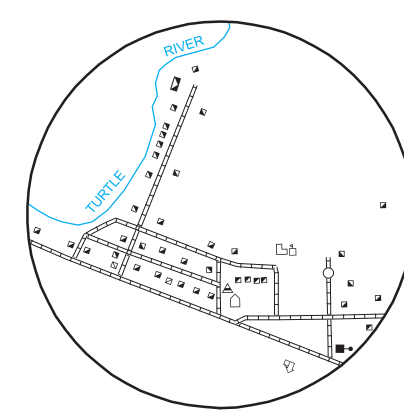

MEKINOCK
 SEC. 1, T. 152 N., R. 53 W.

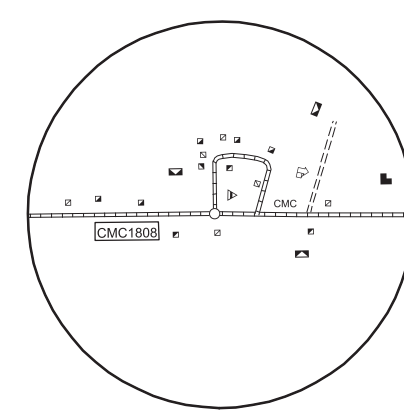

ORR
 SEC'S 2 & 11, T. 153 N., R. 55 W.



STATE OF NORTH DAKOTA
 DIAGRAM OF COUNTIES

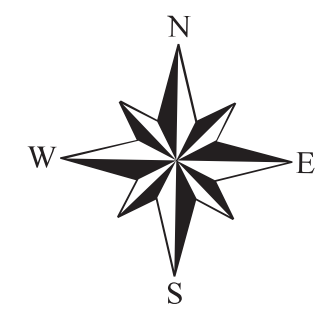

GENERAL HIGHWAY MAP GRAND FORKS COUNTY NORTH DAKOTA

PREPARED BY THE
 NORTH DAKOTA DEPARTMENT OF TRANSPORTATION
 PLANNING / ASSET MANAGEMENT DIVISION
 IN COOPERATION WITH THE
 U.S. DEPARTMENT OF TRANSPORTATION
 FEDERAL HIGHWAY ADMINISTRATION

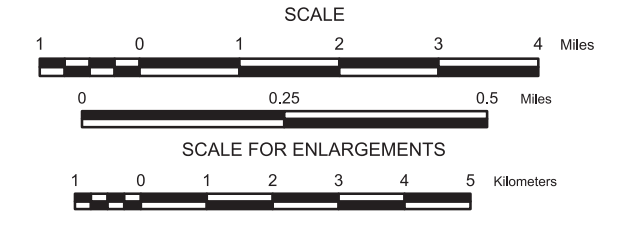

2012

BASED ON AERIAL PHOTOGRAPHY OF 1954
 GRAND INVENTORY OF 2012
 AERIAL INVENTORY OF 2012

UNIVERSAL TRANSVERSE MERCATOR ZONE 14
 NORTH AMERICAN DATUM 83

Notice of Disclaimer
 The North Dakota Department of Transportation (NDDOT) makes this map available on an "as is" basis as a public service. Under no circumstances does NDDOT warrant or certify the information to be free of errors or deficiencies of any kind. NDDOT specifically disclaims all warranties, express or implied, including but not limited to the warranties of merchantability and fitness for a particular purpose.

COPIES OF THIS MAP ARE AVAILABLE FOR PUBLIC USE AT A NOMINAL COST FROM:
 MAP SALES, N.D. DEPT. OF TRANSPORTATION, 608 E. BLVD. AVE., BISMARCK, N.D. 58505-0700