

INSET NO. 2
SEC. 18, T. 133 N., R. 61 W.

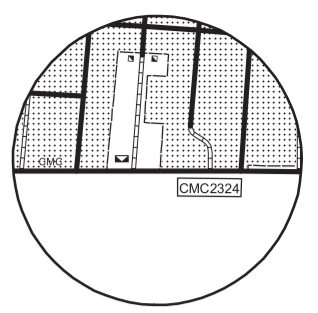

INSET NO. 3
SEC. 28 & 35, T. 133 N., R. 66 W.

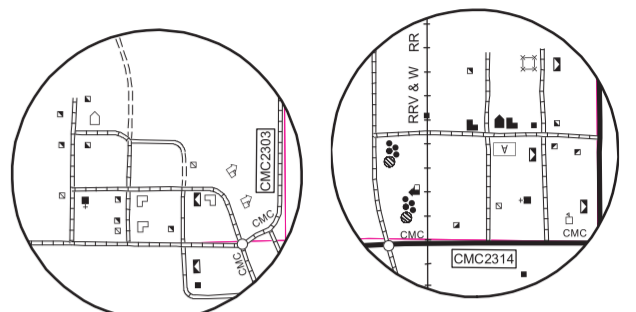

ALFRED
SEC. 8, 9, 16, & 17,
T. 136 N., R. 66 W.

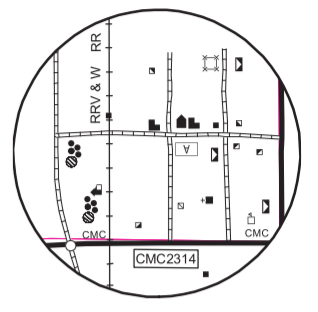

GRAND RAPIDS
SEC. 4, 5, 8, & 9,
T. 134 N., R. 61 W.

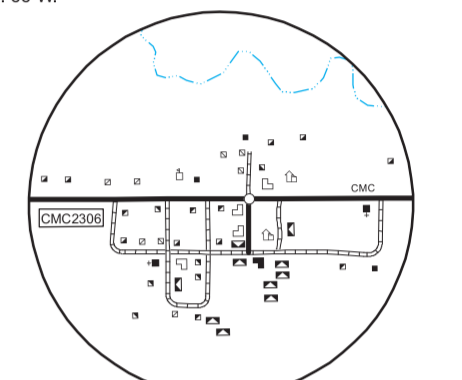

NORTONVILLE
SEC. 28, 29, 32, & 33, T. 136 N., R. 64 W.

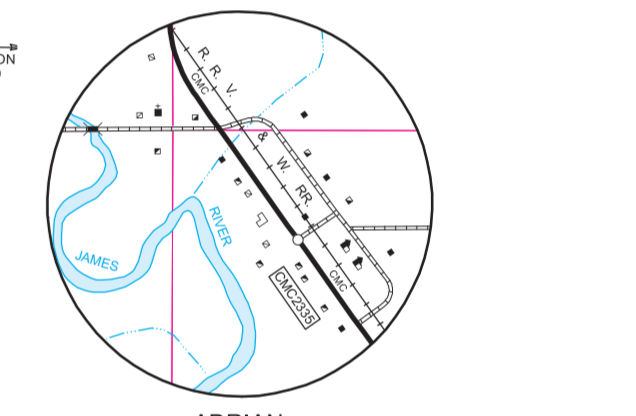

ADRIAN
SEC. 11, 12, 13, & 14, T. 136 N., R. 63 W.

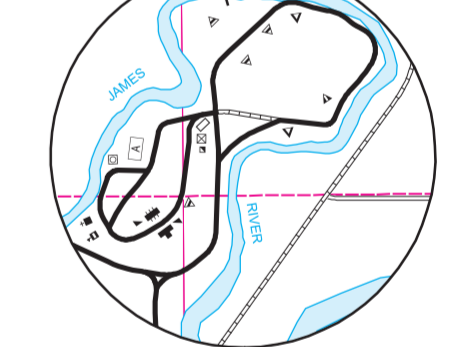

INSET NO. 1
SEC. 32 & 33, T. 135 N., R. 61 W.

SEC. 4 & 5, T. 134 N., R. 61 W.

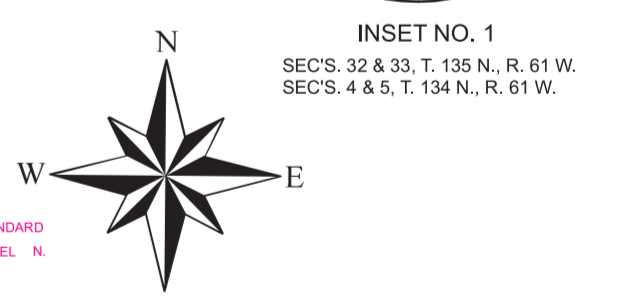

GENERAL LEGEND

ROADS AND ROADWAY FEATURES	BOUNDARIES	PUBLIC SERVICE FACILITIES	FARM UNITS, DWELLINGS, ETC.
PRIMITIVE ROAD	COUNTY LINE	GARBAGE OR RUBBISH DUMP	FARM UNIT LINE (FARM UNITS SHOWN IN
UNIMPROVED ROAD	TOWNSHIP LINE	SEWAGE DISPOSAL PLANT	MUNICIPAL LIMITS INDICATE FARM
GRADED AND DRAINED ROAD	CORPORATE LINE	AUTOMOBILE GRAVEYARD	BUILDINGS OR FARM USE)
GRAVEL GRADED AND DRAINED ROAD	SECTION LINE	WATER SUPPLY STAND PIPE OR TANK	DWELLING OTHER THAN FARM
PAVED ROAD	BOUNDARY TO MARK	POWER SUBSTATION	ROWS OR GROUPS OF DWELLINGS
STREETS IN UNINCORPORATED AREAS	ENLARGEMENT INSET	FILING STATION	CLOSELY SPACED (FIGURE DENOTES
COUNTY MAJOR COLLECTOR	NATIONAL REFUGES	WAREHOUSE - GENERAL	NUMBER OF DWELLINGS)
ROUTE NUMBER	MONUMENT - SMALL, HISTORIC SITE	GROUP OF STORAGE TANKS	BARACKS, OR DORMATORIES FOR
POINTS BETWEEN WHICH	WILDLIFE MANAGEMENT AREA	WATER TOWER	STUDENTS, WORKERS, MIGRANTS, ETC.
DISTANCES ARE MEASURED	WATERFOWL PRODUCTION AREA	WIND TURBINE	SEASONAL OR SUMMER COLONY
U.S. NUMBERED HIGHWAY	LAKE, RESERVOIR, OR POND	AIRPORTS	DWELLING
STATE HIGHWAY SYSTEM	LAKE, RESERVOIR, OR POND	LANDING AREA OR STRIP	SEASONAL DWELLINGS CLOSELY
STRUCTURES	WITH DAM		SPACED
HIGHWAY BRIDGE, GENERAL	MARSH OR SWAMP LAND		HOTEL OR INN
DAM WITH ROAD	DRAINAGE		SCHOOLHOUSE
MINOR DRAINAGE STRUCTURE	INTERMITTENT STREAM (NARROW)		CHURCH AND SCHOOL
FORD - ROAD ESTABLISHED	NARROW STREAM		TOWNHALL, GRANGE, OR
NAVIGATION	WIDE STREAM		COMMUNITY HALL
DOCK, PIER, OR LANDING	WIDE STREAM WITH DAM		MUSEUM - GENERAL
RAILROADS	LAKE, RESERVOIR, OR POND		MISCELLANEOUS
RAILROAD (ANY NUMBER OF TRACKS	LAKE, RESERVOIR, OR POND		TRIANGULATION STATION
USED BY A SINGLE OPERATING CO.)	WITH DAM		DOT TO INDICATE LOCATION OF
RAILROAD STATION	MARSH OR SWAMP LAND		ANY CULTURAL FEATURE
RAILROAD ABOVE	DRAINAGE DITCH		SHOWN OUT OF POSITION
	IRRIGATION DITCH		ALL VACANT CULTURE INDICATED
	CANAL		BY OPEN SYMBOL
			(GENERALIZED)
			LATITUDE AND LONGITUDE

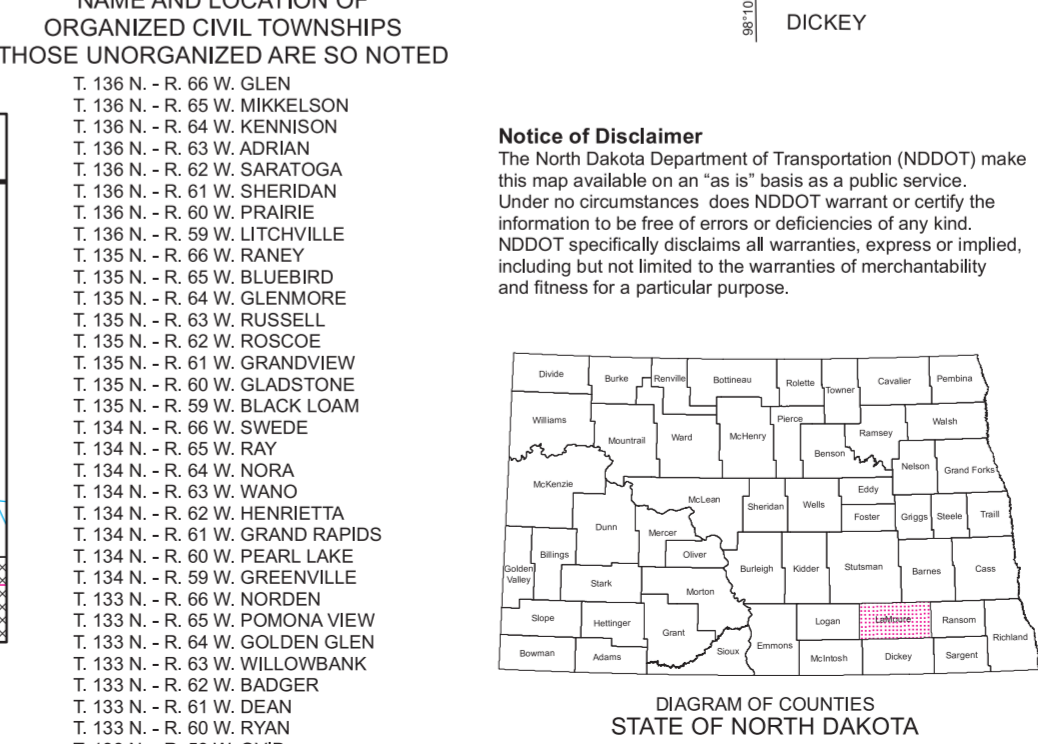
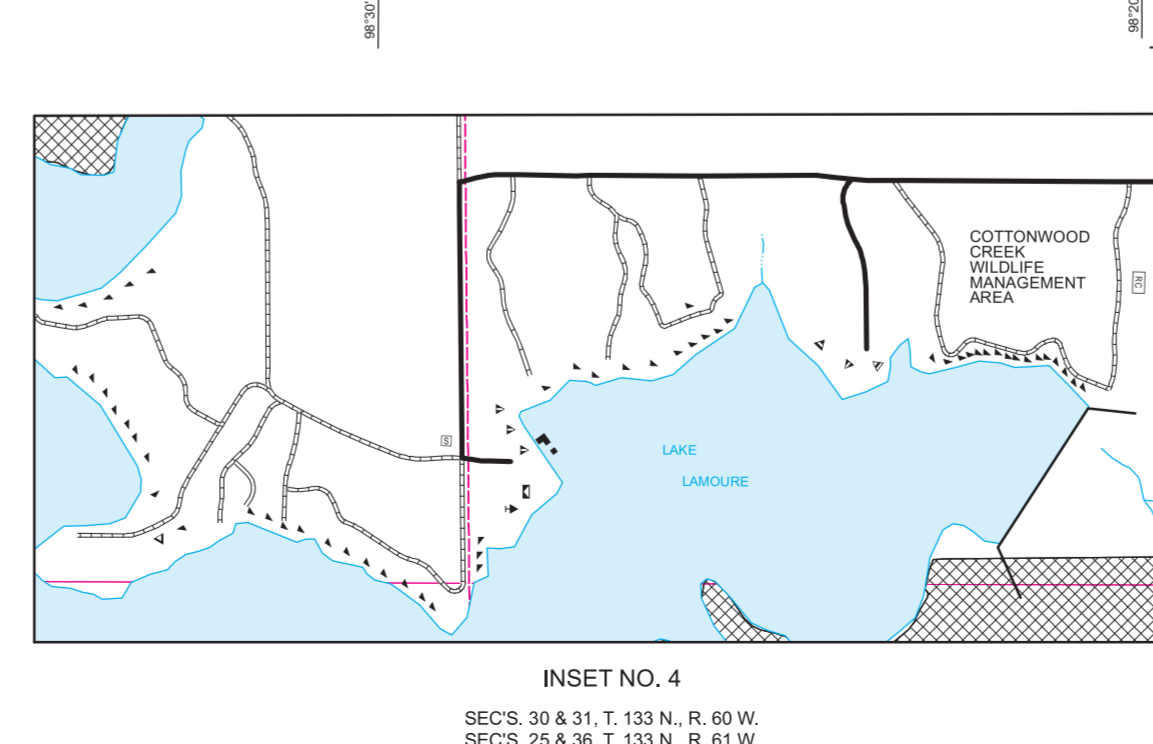

GENERAL HIGHWAY MAP
LaMOURE COUNTY
NORTH DAKOTA

PREPARED BY THE
NORTH DAKOTA DEPARTMENT OF TRANSPORTATION
 PLANNING / ASSET MANAGEMENT DIVISION

IN COOPERATION WITH THE
U.S. DEPARTMENT OF TRANSPORTATION
 FEDERAL HIGHWAY ADMINISTRATION

SCALE
 0 1 2 3 4 Miles
 0 0.25 0.5 Kilometers

2014

BASED ON AERIAL PHOTOGRAPHY OF 1957
 GROUND INVENTORY OF 2014
 AERIAL INVENTORY OF 2014

UNIVERSAL TRANSVERSE MERCATOR ZONE 14
 NORTH AMERICAN DATUM 83
 SHEET 1 OF 1