

INSET NO. 1  
SEC. 24, T. 152 N., R. 96 W.

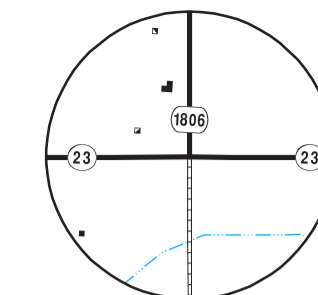

INSET NO. 2  
SEC'S. 17, 18, 19, & 20, T. 152 N., R. 95 W.

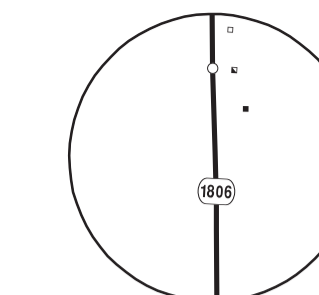

CHARLSON  
SEC'S. 22, & 23, T. 153 N., R. 95 W.

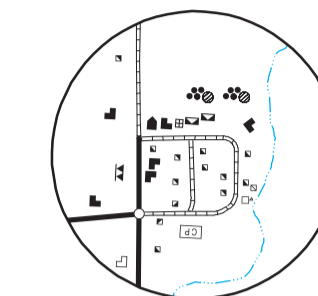

KEENE  
SEC'S. 2, & 3, T. 151 N., R. 96 W.

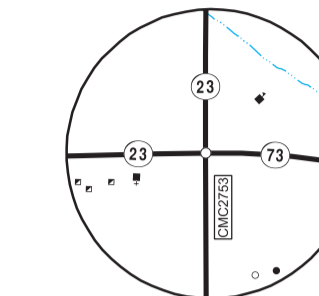

JOHNSON'S CORNER  
SEC'S. 14, 15, 22, & 23, T. 150 N., R. 96 W.

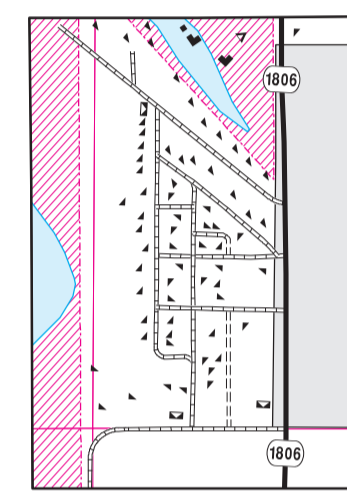

TOBACCO GARDEN  
SEC'S. 1, 2, 11, & 12, T. 153 N., R. 97 W.

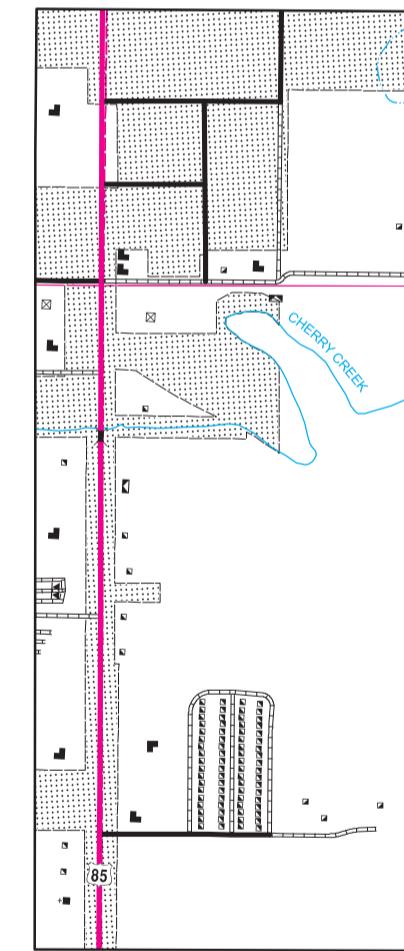

INSET NO. 3  
SEC. 30, T. 150 N., R. 98 W.  
SEC. 25, T. 150 N., R. 99 W.

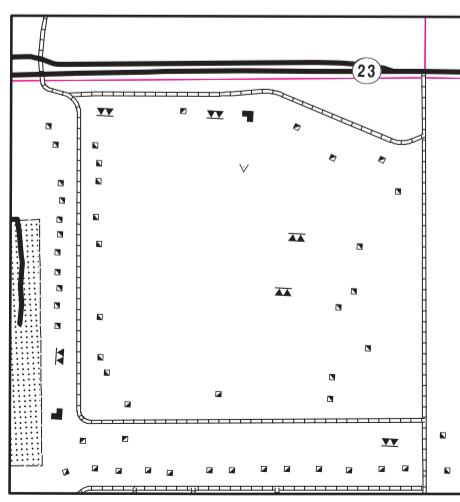

INSET NO. 4  
SEC'S. 14, 15, 22, & 23, T. 150 N., R. 98 W.

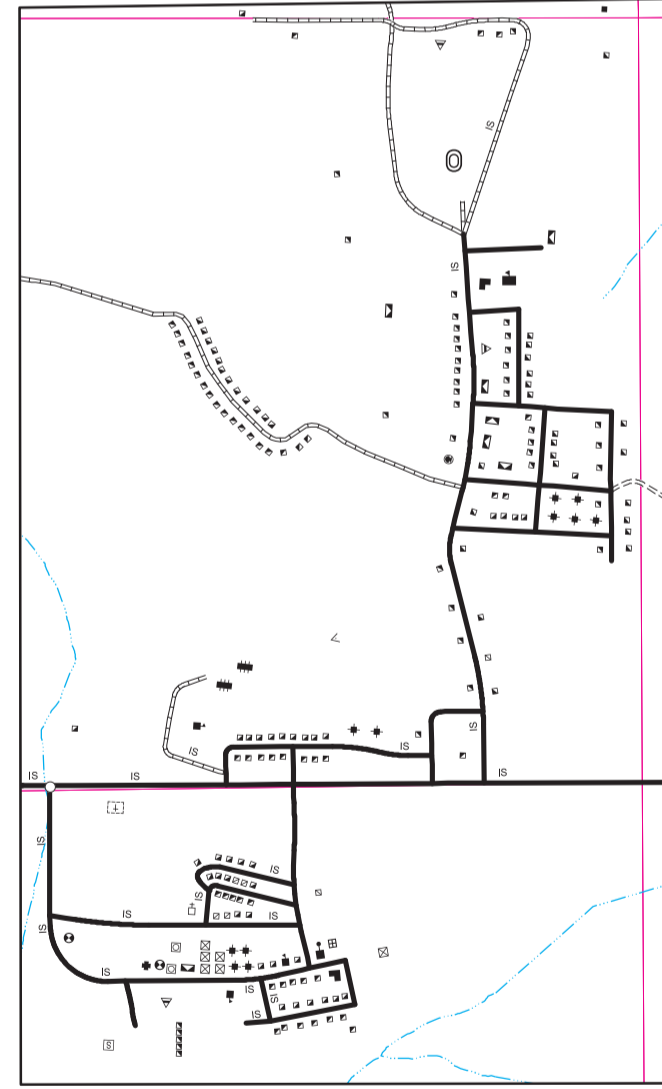

MANDAREE  
WESTERN SEGMENT  
SUB AGENCY  
SEC'S. 11 & 14, T. 149 N., R. 94 W.

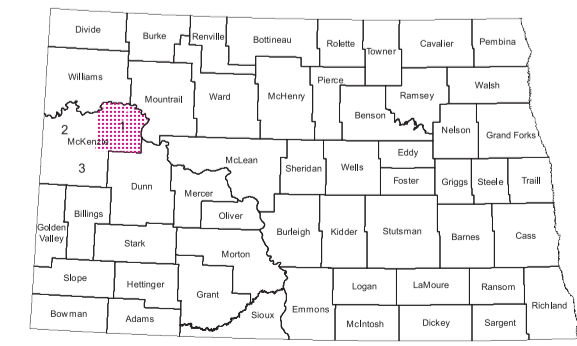

STATE OF NORTH DAKOTA  
DIAGRAM OF COUNTIES

GENERAL LEGEND

- FARM UNITS, DWELLINGS, ETC.**
- FARM UNIT (FARM UNITS SHOWN IN MUNICIPAL LIMITS INDICATE FARM BUILDINGS FOR FARM USE) .....
- ROWS OR GROUPS OF DWELLINGS .....
- CLOSELY SPACED (FIGURE DENOTES NUMBER OF DWELLINGS) .....
- BARRACKS, OR DORMATORIES FOR STUDENTS, WORKERS, IMMIGRANTS, ETC. ....
- SEASONAL OR SUMMER COLONY .....
- DWELLING .....
- SEASONAL DWELLINGS CLOSELY SPACED .....
- CHURCH .....
- CEMETERY .....
- WELL .....
- TOLL HOUSE, STATE PORT OF ENTRY, OR WEIGHT STATION .....
- TENANT HOUSE .....
- PUBLIC SERVICE FACILITIES**
- POST OFFICE .....
- HIGHWAY GARAGE .....
- FIRE ENGINE HOUSE .....
- GARAGE OR RUBBISH DUMP .....
- SEWAGE DISPOSAL PLANT .....
- SANITARY FILL .....
- AUTOMOBILE GRAVEYARD .....
- WATER SUPPLY STAND PIPE OR TANK .....
- POWER SUBSTATION .....
- BOOSTER STATION .....
- COMMUNICATION TOWER .....
- POLICE STATION .....
- MUNICIPAL BUILDING .....
- COURTHOUSE .....
- CONSERVATION AND RECREATION**
- PICNIC GROUND .....
- PLAYGROUND, BALL FIELD, ETC. ....
- SCENIC SITE .....
- CAMP SITE, NO PERMANENCE (TENTS OR TRAILER PARKING) .....
- TOURIST COURT, MAN CAMP, OR MOTEL .....
- REST AREA .....
- SMALL PARK (SP-STATE, CP-COUNTY, MP-MUNICIPAL, WP-WAYSIDE PARK) .....
- GOLF GROUND OR COUNTRY CLUB .....
- AMUSEMENT PARK OR LAKE .....
- FAIR GROUND, RACE COURSE, SPEEDWAY .....
- GUIDE HOUSE OR GATE HOUSE .....
- INDUSTRIAL**
- STORE OR SMALL BUSINESS .....
- ESTABLISHMENT .....
- FACTORY OR INDUSTRIAL PLANT .....
- GAS TANK .....
- GROUP OF STORAGE TANKS (OIL OR GAS) .....
- FILLING STATION .....
- PUMPING STATION (OIL OR GAS) .....
- GAUGING OR PUMPING STATION .....
- WAREHOUSE - GENERAL .....
- GRAIN ELEVATOR .....
- BEEHIVE .....
- BEET DUMP .....
- GRAVEL PIT .....
- OIL OR GAS WELL .....
- MINE - SHAFT OR DRIFT (ANY KIND) .....
- EDUCATIONAL AND CORRECTIONAL INSTITUTIONS**
- TOWNHALL, GRANGE, OR COMMUNITY HALL .....
- MUSEUM - GENERAL .....
- CITY AND VILLAGE CENTERS**
- COUNTY SEAT .....
- OTHER CITIES AND VILLAGES .....
- INCORPORATED CITY OR VILLAGE (GENERALIZED) .....
- ROADS AND ROADWAY FEATURES**
- PRIMITIVE ROAD .....
- UNIMPROVED ROAD .....
- GRADED AND DRAINED ROAD .....
- GRAVEL GRADED AND DRAINED ROAD .....
- PAVED ROAD .....
- STREETS IN UNINCORPORATED AREAS .....
- INDIAN SERVICE ROAD .....
- COUNTY MAJOR COLLECTOR .....
- ROUTE NUMBER .....
- POINTS BETWEEN WHICH DISTANCES ARE MEASURED .....
- U.S. NUMBERED HIGHWAY .....
- STATE HIGHWAY SYSTEM .....
- STRUCTURES**
- HIGHWAY BRIDGE, GENERAL .....
- HIGHWAY GRADE SEPARATION .....
- DAM WITH ROAD .....
- MINOR DRAINAGE STRUCTURE .....
- CONCRETE FORD OR DIP .....
- FORD - ROAD ESTABLISHED TRUSS OR GIRDER .....
- RAILROADS**
- RAILROAD (ANY NUMBER OF TRACKS USED BY A SINGLE OPERATING CO.) .....
- RAILROAD STATION .....
- BOUNDARIES**
- STATE OR PROVINCE LINE .....
- COUNTY LINE .....
- TOWNSHIP LINE .....
- CORPORATE LINE .....
- SECTION LINE .....
- MATCH LINE BETWEEN ADJOINING SHEETS OF SAME COUNTY .....
- BOUNDARY TO MARK ENLARGEMENT INSET .....
- NATIONAL REFUGES .....
- MONUMENT - SMALL, HISTORIC SITE .....
- WILDLIFE MANAGEMENT AREA .....
- WATERFOWL PRODUCTION AREA .....
- STATE PARKS .....
- STATE SCHOOL LAND .....
- NATIONAL GRASSLANDS .....
- RESERVOIR BOUNDARY (TAKING LINE) .....
- NATIONAL PARKS AND OTHER RESERVATIONS .....
- DRAINAGE**
- INTERMITTENT STREAM (NARROW) .....
- NARROW STREAM .....
- WIDE STREAM .....
- WIDE STREAM WITH DAM .....
- LAKE, RESERVOIR, OR POND .....
- LAKE, RESERVOIR, OR POND WITH DAM .....
- MARSH OR SWAMP LAND .....
- DRAINAGE DITCH .....
- NAVIGATION**
- DOCK, PIER, OR LANDING .....
- NATURAL FEATURES**
- PROMINENT ELEVATION - WITH NAME .....
- MISCELLANEOUS**
- TRIANGULATION STATION .....
- DOT TO INDICATE LOCATION OF ANY CULTURAL FEATURE SHOWN OUT OF POSITION .....
- ALL VACANT CULTURE INDICATED BY OPEN SYMBOL .....
- LATITUDE AND LONGITUDE .....
- AIRPORTS**
- AIRFIELD, LIMITED FACILITIES .....
- LANDING AREA OR STRIP .....

**Notice of Disclaimer**  
The North Dakota Department of Transportation (NDDOT) makes this map available on an "as is" basis as a public service. Under no circumstances does NDDOT warrant or certify the information to be free of errors or deficiencies of any kind. NDDOT specifically disclaims all warranties, express or implied, including but not limited to the warranties of merchantability and fitness for a particular purpose.

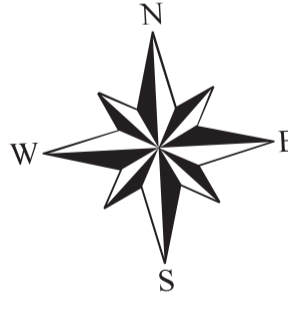

# GENERAL HIGHWAY MAP McKENZIE COUNTY NORTH DAKOTA

PREPARED BY THE  
NORTH DAKOTA DEPARTMENT OF TRANSPORTATION  
PLANNING / ASSET MANAGEMENT DIVISION  
IN COOPERATION WITH THE  
U.S. DEPARTMENT OF TRANSPORTATION  
FEDERAL HIGHWAY ADMINISTRATION

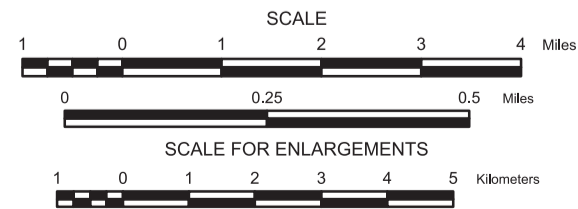

2013

BASED ON AERIAL PHOTOGRAPHY OF 1958  
GROUND INVENTORY OF 2013  
AERIAL INVENTORY OF 2013

UNIVERSAL TRANSVERSE MERCATOR ZONE 14  
NORTH AMERICAN DATUM 83