

2007 FUNCTIONAL CLASSIFICATION

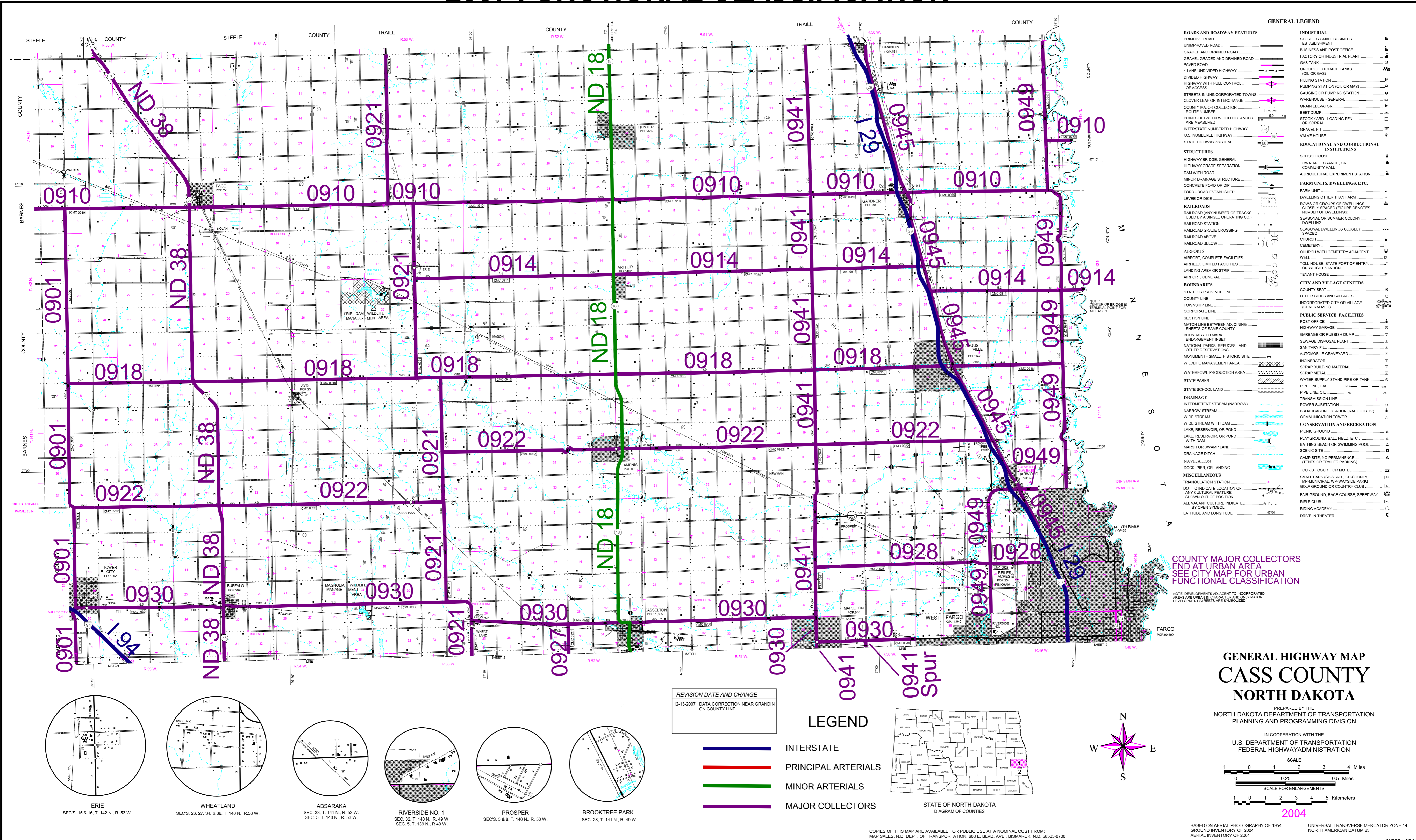

GENERAL LEGEND

ROADS AND ROADWAY FEATURES	INDUSTRIAL
PRIMITIVE ROAD	STORE OR SMALL BUSINESS ESTABLISHMENT
UNIMPROVED ROAD	BUSINESS AND POST OFFICE
GRAVEL GRADED AND DRAINED ROAD	FACTORY OR INDUSTRIAL PLANT
GRAVEL GRADED AND DRAINED ROAD	GAS TANK
PAVED ROAD	GROUP OF STORAGE TANKS (OIL OR GAS)
4 LANE UNDIVIDED HIGHWAY	FILLING STATION
DIVIDED HIGHWAY	PUMPING STATION (OIL OR GAS)
HIGHWAY WITH FULL CONTROL OF ACCESS	GAUGING OR PUMPING STATION
STREETS IN UNINCORPORATED TOWNS	WAREHOUSE - GENERAL
CLOVER LEAF OR INTERCHANGE	GRAN ELEVATOR
COUNTY MAJOR COLLECTOR ROUTE NUMBER	BEEF DUMP
POINTS BETWEEN WHICH DISTANCES ARE MEASURED	STOCK YARD - LOADING PEN OR CORRAL
INTERSTATE NUMBERED HIGHWAY	GRAVEL PIT
U.S. NUMBERED HIGHWAY	VALVE HOUSE
STATE HIGHWAY SYSTEM	EDUCATIONAL AND CORRECTIONAL INSTITUTIONS
STRUCTURES	SCHOOLHOUSE
HIGHWAY BRIDGE, GENERAL	TOWNHALL, GRANGE, OR COMMUNITY HALL
HIGHWAY GRADE SEPARATION	AGRICULTURAL EXPERIMENT STATION
DAM WITH ROAD	FARM UNITS, DWELLINGS, ETC.
MINOR DRAINAGE STRUCTURE	FARM UNIT
CONCRETE FORD OR DIP	DWELLING OTHER THAN FARM
FORD - ROAD ESTABLISHED	ROWS OR GROUPS OF DWELLINGS
LEEVE OR DIKE	CLOSELY SPACED FIGURE DENOTES NUMBER OF DWELLINGS
RAILROADS	SEASONAL OR SUMMER COLONY DWELLING
RAILROAD (ANY NUMBER OF TRACKS USED BY A SINGLE OPERATING CO.)	SEASONAL DWELLINGS CLOSELY SPACED
RAILROAD STATION	CHURCH
RAILROAD GRADE CROSSING	CEMETERY
RAILROAD ABOVE	CHURCH WITH CEMETERY ADJACENT
RAILROAD BELOW	WELL
AIRPORTS	TOLL HOUSE, STATE PORT OF ENTRY, OR WEIGHT STATION
AIRPORT, COMPLETE FACILITIES	TENANT HOUSE
AIRFIELD, LIMITED FACILITIES	CITY AND VILLAGE CENTERS
LANDING AREA OR STRIP	COUNTY SEAT
AIRPORT, GENERAL	OTHER CITIES AND VILLAGES (GENERALIZED)
BOUNDARIES	INCORPORATED CITY OR VILLAGE (GENERALIZED)
STATE OR PROVINCE LINE	CORPORATE LINE
COUNTY LINE	SECTION LINE
TOWNSHIP LINE	MATCH LINE BETWEEN ADJOINING SHEETS OF SAME COUNTY
CORPORATE LINE	BOUNDARY TO MARK ENLARGEMENT INSET
GENERAL SERVICE FACILITIES	NATIONAL PARKS, REFUGES, AND OTHER RESERVATIONS
POST OFFICE	MONUMENT - SMALL HISTORIC SITE
HIGHWAY GARAGE	WILDLIFE MANAGEMENT AREA
GARAGE OR RUBBISH DUMP	WATERPOW! PRODUCTION AREA
BERGAGE DISPOSAL PLANT	STATE PARKS
SANITARY FILL	STATE SCHOOL LAND
AUTOMOBILE GRAVEYARD	DRAINAGE
INCINERATOR	INTERMITTENT STREAM (NARROW)
SCRAP BUILDING MATERIAL	NARROW STREAM
SCRAP METAL	WIDE STREAM
WATER SUPPLY STAND PIPE OR TANK	WIDE STREAM WITH DAM
PIPE LINE, GAS	LAKE, RESERVOIR, OR POND WITH DAM
PIPE LINE, OIL	LAKE, RESERVOIR, OR POND
TRANSMISSION LINE	MARSH OR SWAMP LAND
POWER SUBSTATION	DRAINAGE DITCH
BROADCASTING STATION (RADIO OR TV)	NAVIGATION
COMMUNICATION TOWER	DOCK, PIER, OR LANDING
CONSERVATION AND RECREATION	MISCELLANEOUS
PICNIC GROUND	TRIANGULATION STATION
PLAYGROUND, BALL FIELD, ETC.	DOT TO INDICATE LOCATION OF ANY CULTURAL FEATURE SHOWN OUT OF POSITION
BATHING BEACH OR SWIMMING POOL	ALL VACANT CULTURE INDICATED BY OPEN SYMBOL
SCENIC SITE	LATITUDE AND LONGITUDE
CAMP SITE, NO PERMANENCE (TENTS OR TRAILER PARKING)	
TOURIST COURT, OR MOTEL	
SMALL PARK (SP-STATE, CP-COUNTY, MP-MUNICIPAL, WFWA-WIDE PARKS)	
GOLF GROUND OR COUNTRY CLUB	
FAIR GROUND, RACE COURSE, SPEEDWAY	
RIFLE CLUB	
RIDING ACADEMY	
DRIVE-IN THEATER	

COUNTY MAJOR COLLECTORS END AT URBAN AREA. SEE CITY MAP FOR URBAN FUNCTIONAL CLASSIFICATION.

NOTE: DEVELOPMENTS ADJACENT TO INCORPORATED AREAS ARE URBAN IN CHARACTER AND ONLY MAJOR DEVELOPMENT STREETS ARE SYMBOLIZED.

REVISION DATE AND CHANGE
12-13-2007 DATA CORRECTION NEAR GRANDIN ON COUNTY LINE

LEGEND

	INTERSTATE
	PRINCIPAL ARTERIALS
	MINOR ARTERIALS
	MAJOR COLLECTORS

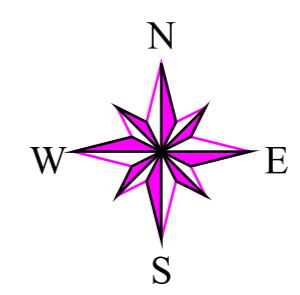

GENERAL HIGHWAY MAP CASS COUNTY NORTH DAKOTA

PREPARED BY THE
NORTH DAKOTA DEPARTMENT OF TRANSPORTATION
PLANNING AND PROGRAMMING DIVISION

IN COOPERATION WITH THE
U.S. DEPARTMENT OF TRANSPORTATION
FEDERAL HIGHWAY ADMINISTRATION

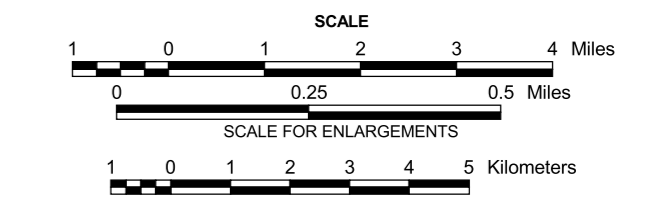

2004

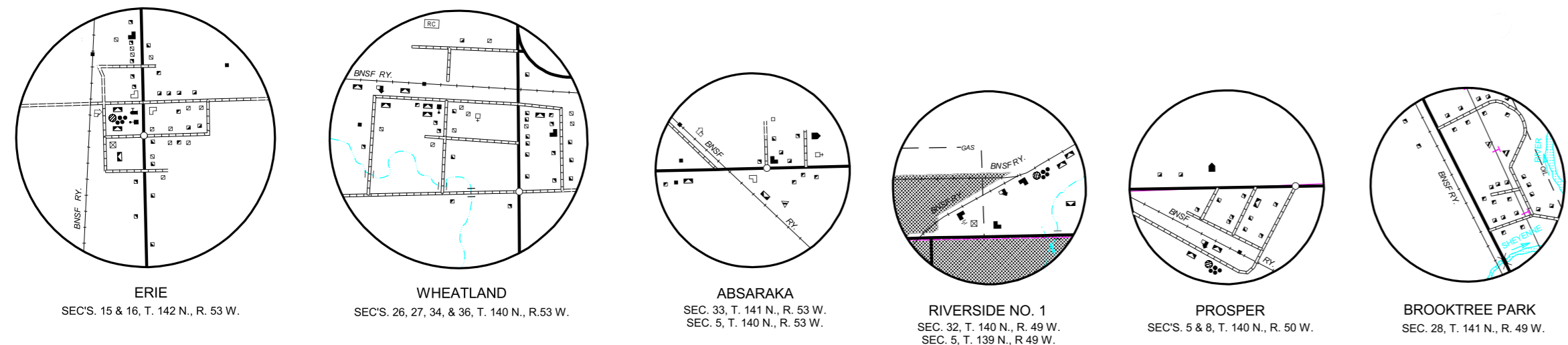

COPIES OF THIS MAP ARE AVAILABLE FOR PUBLIC USE AT A NOMINAL COST FROM:
MAP SALES, N.D. DEPT. OF TRANSPORTATION, 608 E. BLVD. AVE., BISMARCK, N.D. 58505-0700

BASED ON AERIAL PHOTOGRAPHY OF 1954
GROUND INVENTORY OF 2004
AERIAL INVENTORY OF 2004

UNIVERSAL TRANSVERSE MERCATOR ZONE 14
NORTH AMERICAN DATUM 83