

2007 FUNCTIONAL CLASSIFICATION

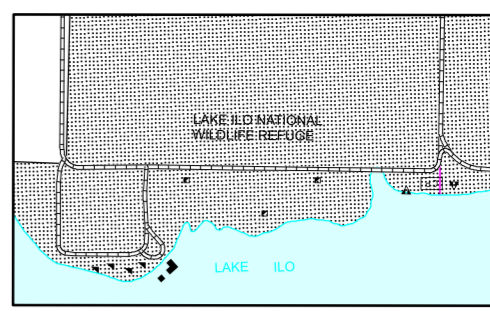

INSET NO. 1
SEC'S. 27 & 28, T. 145 N., R. 94 W.

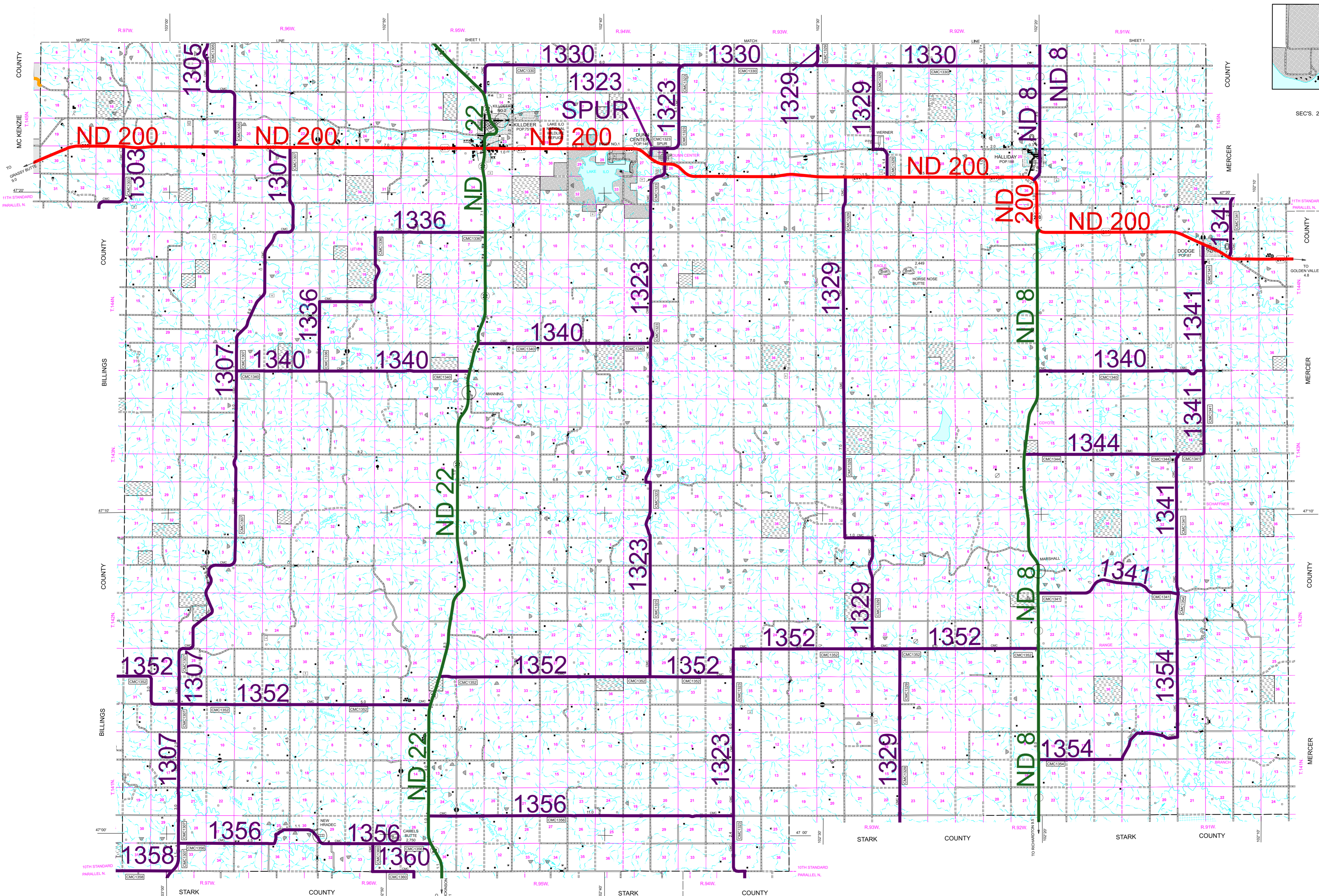
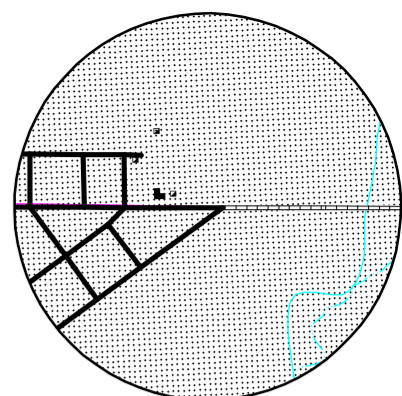

KILLDEER NO. 2
SEC'S. 14, & 23, T. 145 N., R. 95 W.

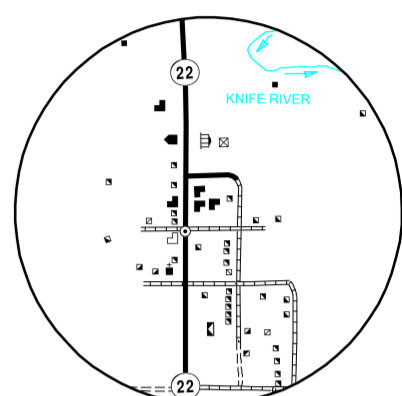

MANNING
SEC. 6, T. 143 N., R. 95 W.

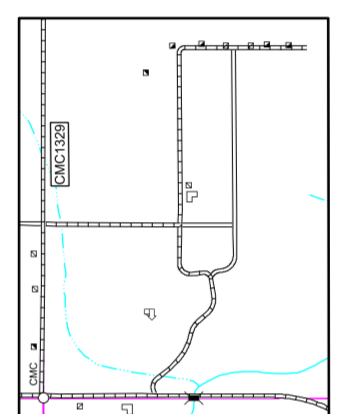

WERNER
SEC. 19, T. 145 N., R. 92 W.

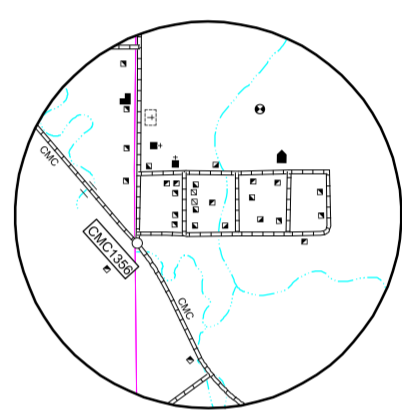

NEW HRADEC
SEC'S. 29, 4, & 30, T. 141 N., R. 96 W.

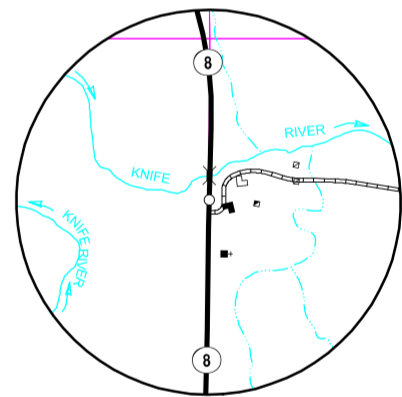
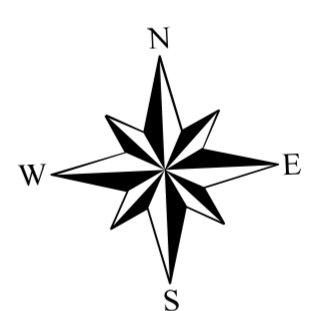

MARSHALL
SEC'S. 3, 4, 9, & 10, T. 142 N., R. 92 W.

LEGEND

- INTERSTATE
- PRINCIPAL ARTERIAL
- MINOR ARTERIAL
- MAJOR COLLECTOR

REVISION DATE AND CHANGE

- 03-13-2013 Added 0.9 miles to CMC1323 Spur
- 05-01-2015 Added 2.5 miles to CMC1360

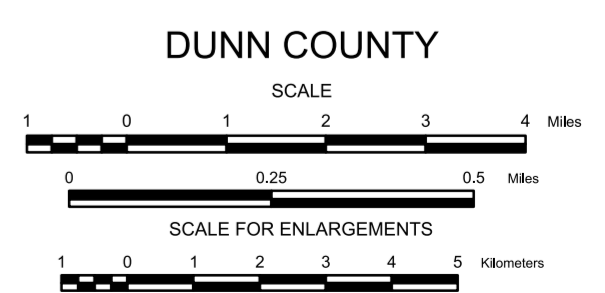

Notice of Disclaimer
The North Dakota Department of Transportation (NDDOT) makes this map available on an "as is" basis as a public service. Under no circumstances does NDDOT warrant or certify the information to be free of errors or deficiencies of any kind. NDDOT specifically disclaims all warranties, express or implied, including but not limited to the warranties of merchantability and fitness for a particular purpose.

2007
BASED ON AERIAL PHOTOGRAPHY OF 1958
GROUND INVENTORY OF 2007
AERIAL INVENTORY OF 2007
UNIVERSAL TRANSVERSE MERCATOR ZONE 14
NORTH AMERICAN DATUM 83
SHEET 2 OF 2