

# 2007 FUNCTIONAL CLASSIFICATION

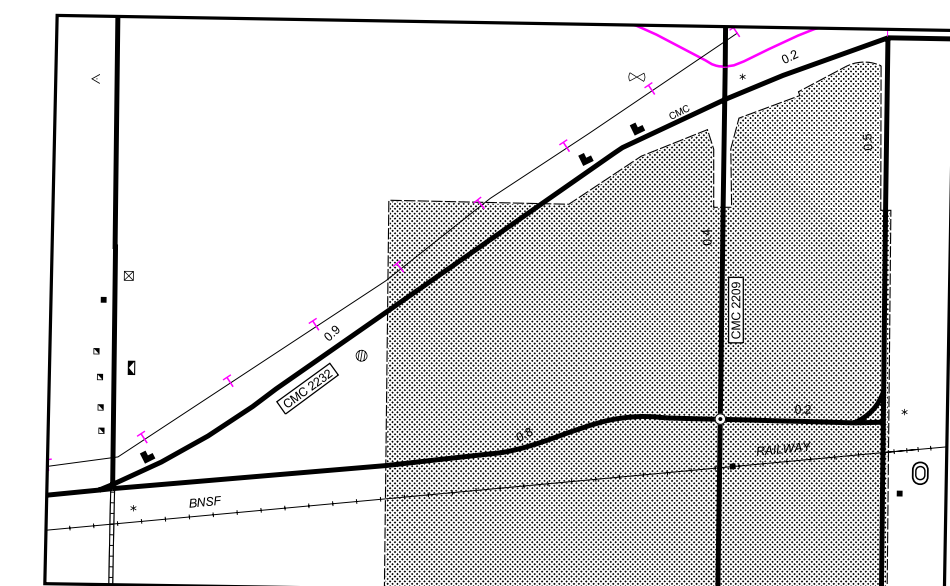
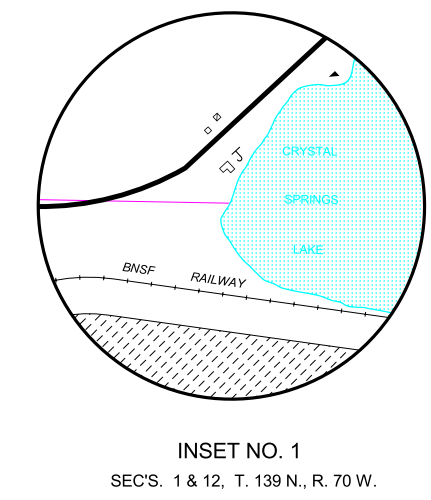
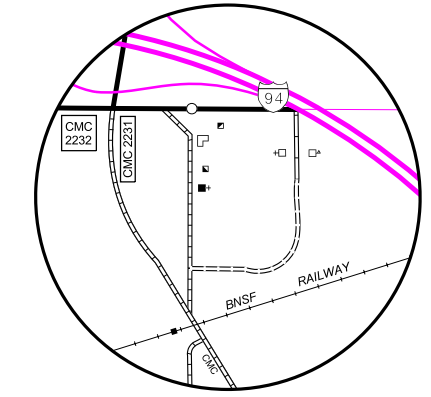
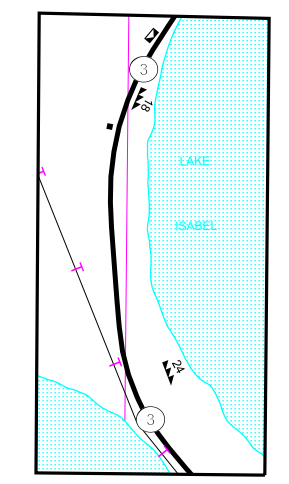
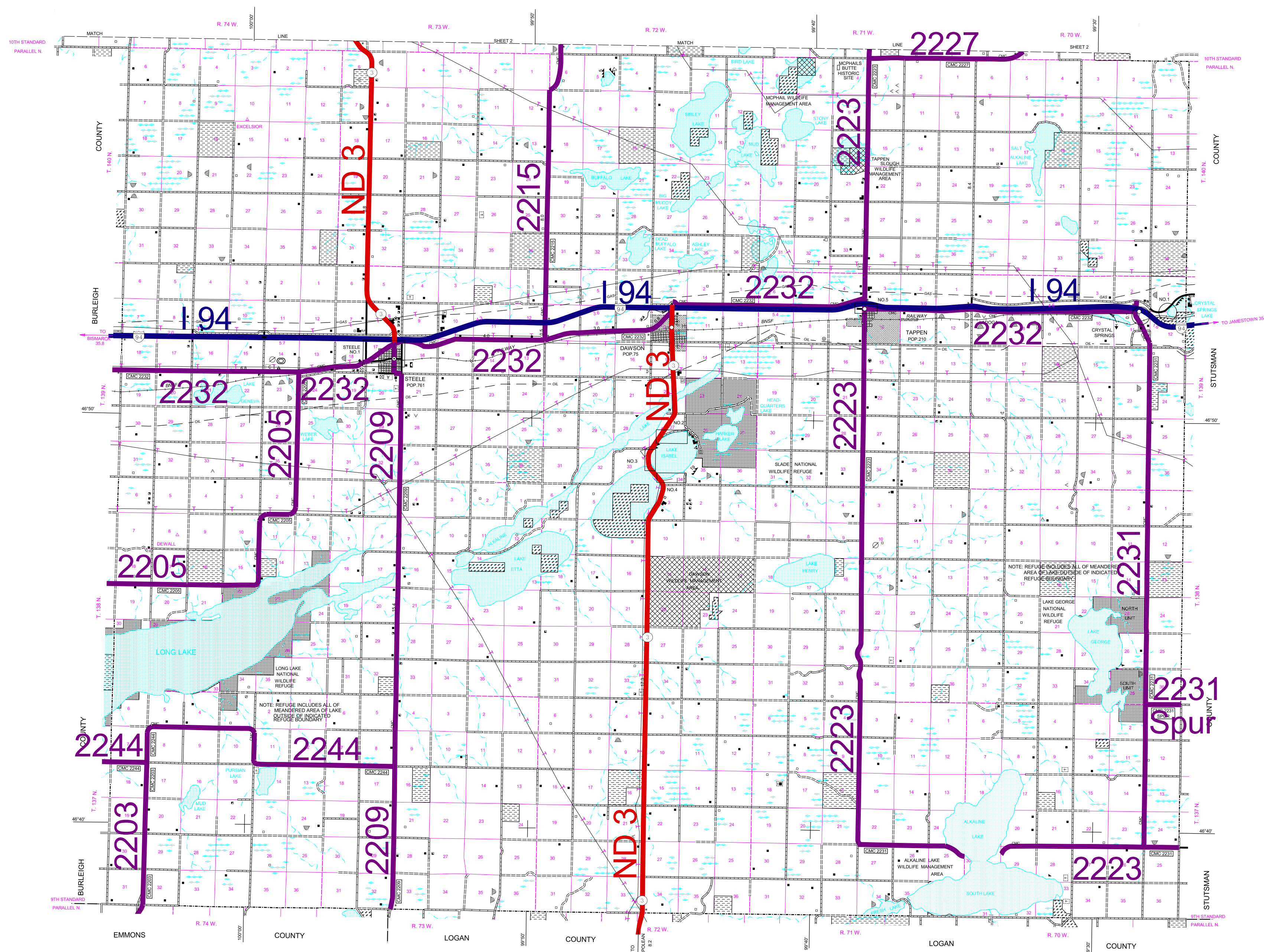

- ROADS AND ROADWAY FEATURES**
- PRIMITIVE ROAD
  - UNIMPROVED ROAD
  - GRADED AND DRAINED ROAD
  - GRAVEL GRADED AND DRAINED ROAD
  - PAVED ROAD
  - DIVIDED HIGHWAY
  - HIGHWAY WITH FULL CONTROL OF ACCESS
  - STREETS IN UNINCORPORATED TOWNS
  - CLOVER LEAF OR INTERCHANGE
  - COUNTY MAJOR COLLECTOR
  - ROUTE NUMBER
  - POINTS BETWEEN WHICH DISTANCES ARE MEASURED
  - INTERSTATE NUMBERED HIGHWAY
  - U.S. NUMBERED HIGHWAY
  - STATE HIGHWAY SYSTEM
- STRUCTURES**
- HIGHWAY BRIDGE, GENERAL
  - FORD - ROAD ESTABLISHED
  - MINOR DRAINAGE STRUCTURE
- RAILROADS**
- RAILROAD (ANY NUMBER OF TRACKS USED BY A SINGLE OPERATING CO.)
  - RAILROAD STATION
  - RAILROAD GRADE CROSSING
- DRAINAGE**
- INTERMITTENT STREAM (NARROW)
  - NARROW STREAM
  - WIDE STREAM
  - LAKE, RESERVOIR, OR POND
  - LAKE, RESERVOIR, OR POND WITH DAM
  - MARSH OR SWAMP LAND
- NAVIGATION**
- DOCK, PIER, OR LANDING

- GENERAL LEGEND**
- BOUNDARIES**
- COUNTY LINE
  - TOWNSHIP LINE
  - CORPORATE LINE
  - SECTION LINE
  - MATCH LINE BETWEEN ADJOINING SHEETS OF SAME COUNTY
  - BOUNDARY TO MARK ENLARGEMENT INSET
  - NATIONAL PARKS, REFUGES, AND OTHER RESERVATIONS
  - MONUMENT - SMALL HISTORIC SITE
  - WATERFOWL PRODUCTION AREA
  - STATE PARKS
  - STATE SCHOOL LAND
- AIRPORTS**
- AIRFIELD, LIMITED FACILITIES
  - LANDING AREA OR STRIP
- EDUCATIONAL AND CORRECTIONAL INSTITUTIONS**
- TOWNHALL, GRANGE, OR COMMUNITY HALL
- PUBLIC SERVICE FACILITIES**
- HIGHWAY GARAGE
  - GARBAGE OR RUBBISH DUMP
  - AUTOMOBILE GRAVEYARD
  - SCRAP BUILDING MATERIAL
  - WATER SUPPLY STAND PIPE OR TANK
  - PIPE LINE, GAS
  - PIPE LINE, OIL
  - TRANSMISSION LINE
  - POWER SUBSTATION
  - COMMUNICATION TOWER
  - MUNICIPAL BUILDING
- INDUSTRIAL**
- STORE OR SMALL BUSINESS ESTABLISHMENT
  - GAS TANK
  - GROUP OF STORAGE TANKS (OIL OR GAS)
  - FILLING STATION
  - PUMPING STATION (OIL OR GAS)
  - WAREHOUSE - GENERAL
  - GRAIN ELEVATOR
  - GRAVEL PIT
  - VALVE HOUSE
- FARM UNITS, DWELLINGS, ETC.**
- FARM UNIT
  - DWELLING OTHER THAN FARM
  - ROWS OR GROUPS OF DWELLINGS CLOSELY SPACED (FIGURE DENOTES NUMBER OF DWELLINGS)
  - SEASONAL OR SUMMER COLONY
  - DWELLINGS SPACED
  - SEASONAL DWELLINGS CLOSELY SPACED
  - CHURCH
  - CHURCH AND SCHOOL
  - CEMETERY
  - CHURCH WITH CEMETERY ADJACENT
- CONSERVATION AND RECREATION**
- PICNIC GROUND
  - BATHING BEACH OR SWIMMING POOL
  - GOLF COURSE OR COUNTRY CLUB
  - AMUSEMENT PARK OR HALL
  - FAIR GROUND, RACE COURSE, SPEEDWAY
  - ROADSIDE SPRING
- CITY AND VILLAGE CENTERS**
- COUNTY SEAT
  - OTHER CITIES AND VILLAGES
  - INCORPORATED CITY OR VILLAGE (GENERALIZED)
- MISCELLANEOUS**
- TRIANGULATION STATION
  - DOT TO INDICATE LOCATION OF ANY CULTURAL FEATURE SHOWN OUT OF POSITION
  - ALL VACANT CULTURE INDICATED BY OPEN SYMBOL
  - LATITUDE AND LONGITUDE

- LEGEND**
- INTERSTATE
  - PRINCIPAL ARTERIALS
  - MINOR ARTERIALS
  - MAJOR COLLECTORS

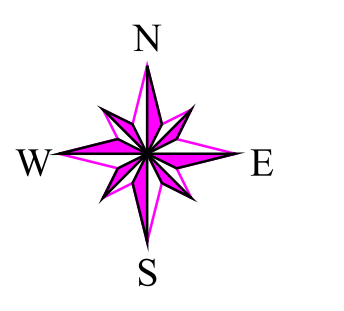

## GENERAL HIGHWAY MAP KIDDER COUNTY NORTH DAKOTA

PREPARED BY THE  
NORTH DAKOTA DEPARTMENT OF TRANSPORTATION  
PLANNING AND PROGRAMMING DIVISION

IN COOPERATION WITH THE  
U.S. DEPARTMENT OF TRANSPORTATION  
FEDERAL HIGHWAY ADMINISTRATION

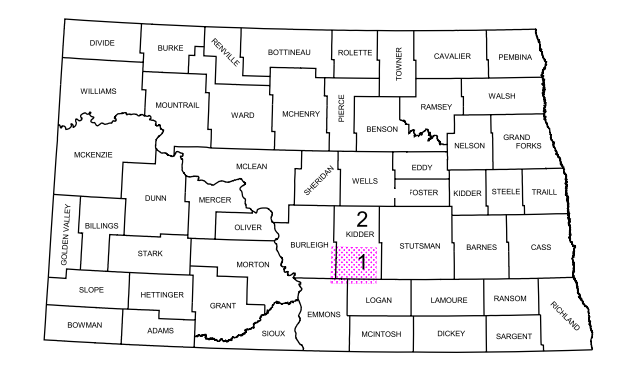
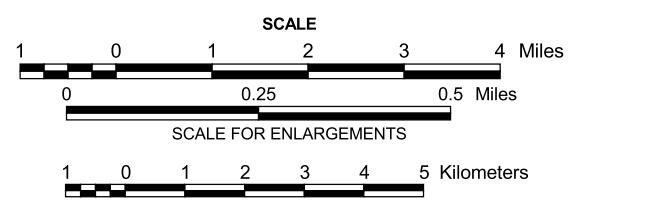

**REVISION DATE AND CHANGE**  
01-10-2008 ADDITION OF 13.5 MILES TO CMC2232

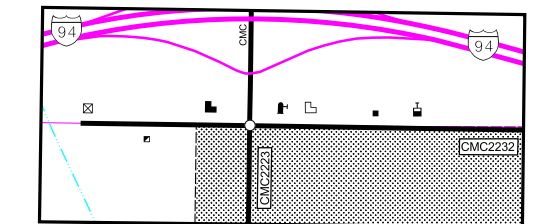
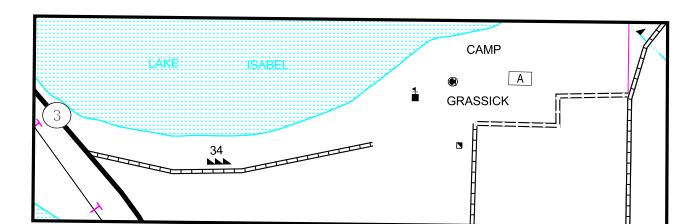
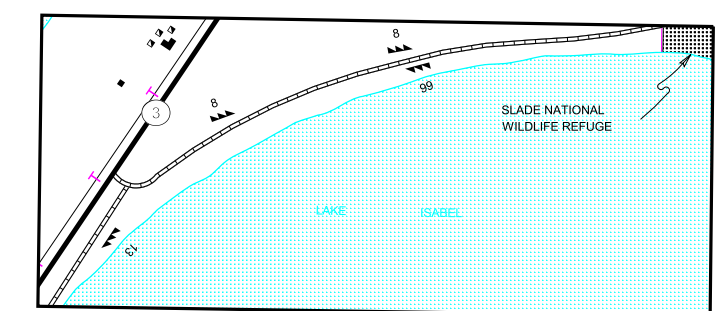

COPIES OF THIS MAP ARE AVAILABLE FOR PUBLIC USE AT A NOMINAL COST FROM:  
MAP SALES, N.D. DEPT. OF TRANSPORTATION, 608 E. BLVD. AVE., BISMARCK, N.D. 58505-0700

BASED ON AERIAL PHOTOGRAPHY OF 1954  
GROUND INVENTORY OF 2004  
AERIAL INVENTORY OF 2004

UNIVERSAL TRANSVERSE MERCATOR ZONE 14  
NORTH AMERICAN DATUM 83