

2007 FUNCTIONAL CLASSIFICATION

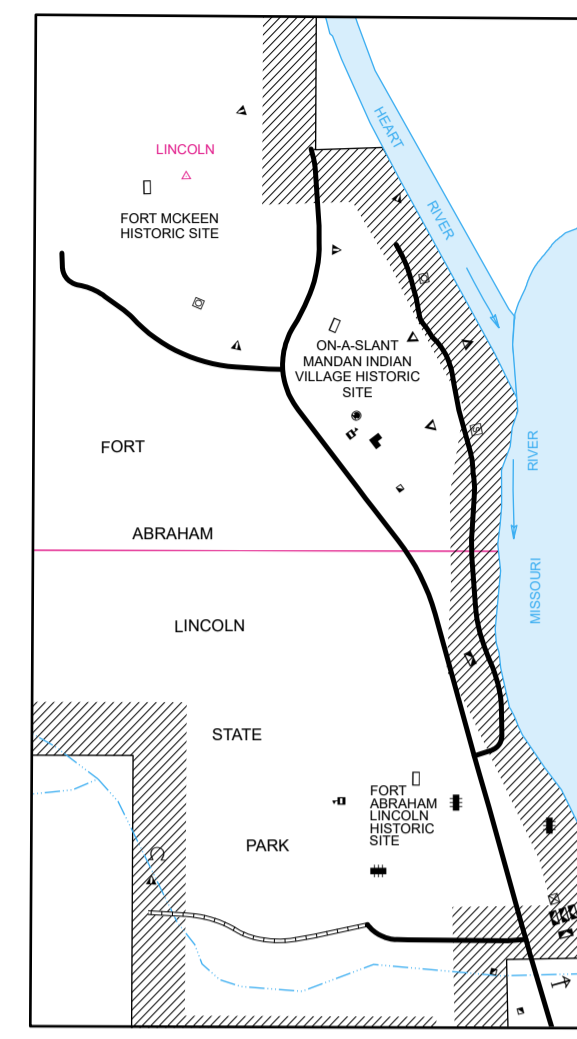

- ROADS AND ROADWAY FEATURES**
- PRIMITIVE ROAD
 - UNIMPROVED ROAD
 - GRADED AND DRAINED ROAD
 - PAVED ROAD
 - STREETS IN UNINCORPORATED AREAS
 - INTERCHANGE
 - COUNTY MAJOR COLLECTOR
 - ROUTE NUMBER
 - POINTS BETWEEN WHICH DISTANCES ARE MEASURED
 - INTERSTATE NUMBERED HIGHWAY
 - U.S. NUMBERED HIGHWAY
 - STATE HIGHWAY SYSTEM
- AIRPORTS**
- AIRFIELD, LIMITED FACILITIES
 - LANDING AREA OR STRIP
 - AIRWAY LIGHT BEACON, GENERAL
 - AIRPORT, GENERAL
- RAILROADS**
- RAILROAD (ANY NUMBER OF TRACKS USED BY A SINGLE OPERATING CO.)
 - RAILROAD STATION
 - RAILROAD GRADE CROSSING
 - RAILROAD BRIDGE
- DRAINAGE**
- INTERMITTENT STREAM (NARROW)
 - NARROW STREAM
 - WIDE STREAM
 - WIDE STREAM WITH DAM
 - LAKE, RESERVOIR, OR POND WITH DAM
 - LAKE, RESERVOIR, OR POND
 - WAREHOUSE - GENERAL
 - MARSH OR SWAMP LAND
 - DRAINAGE DITCH
- STRUCTURES**
- HIGHWAY BRIDGE, GENERAL
 - HIGHWAY GRADE SEPARATION
 - DAM WITH ROAD
 - MINOR DRAINAGE STRUCTURE
 - CONCRETE FORD OR DIP
 - FORD - ROAD ESTABLISHED
 - TRUSS OR GIRDER
 - LEVEE OR DIKE
- NAVIGATION**
- DOCK, PIER, OR LANDING
- NATURAL FEATURES**
- PROMINENT ELEVATION - WITH NAME

- BOUNDARIES**
- COUNTY LINE
 - TOWNSHIP LINE
 - CORPORATE LINE
 - SECTION LINE
 - MATCH LINE BETWEEN ADJOINING SHEETS OF SAME COUNTY
 - BOUNDARY TO MARK ENLARGEMENT INSET
 - NATIONAL REFUGES
 - MONUMENT - SMALL, HISTORIC SITE
 - WILDLIFE MANAGEMENT AREA
 - WATERFOWL PRODUCTION AREA
 - STATE PARKS
 - STATE SCHOOL LAND
 - RESERVOIR BOUNDARY (TAKING LINE)
- EDUCATIONAL AND CORRECTIONAL INSTITUTIONS**
- SCHOOLHOUSE
 - TOWNHALL, GRANGE, OR COMMUNITY HALL
 - MUSEUM - GENERAL
- INDUSTRIAL**
- STORE OR SMALL BUSINESS ESTABLISHMENT
 - FACTORY OR INDUSTRIAL PLANT
 - OIL TANK
 - GAS TANK
 - GROUP OF STORAGE TANKS (OIL OR GAS)
 - FILLING STATION
 - PUMPING STATION (OIL OR GAS)
 - GAUGING OR PUMPING STATION
 - WAREHOUSE - GENERAL
 - GRAIN ELEVATOR
 - STOCK YARD - LOADING PEN OR CORRAL
 - GRAVEL PIT
 - NURSERY
- PUBLIC SERVICE FACILITIES**
- POST OFFICE
 - HIGHWAY GARAGE
 - FIRE ENGINE HOUSE
 - GARBAGE OR RUBBISH DUMP
 - SEWAGE DISPOSAL PLANT
 - AUTOMOBILE GRAVEYARD
 - SCRAP METAL
 - WATER SUPPLY STAND PIPE OR TANK
 - POWER PLANT
 - POWER SUBSTATION
 - BOOSTER STATION
 - BROADCASTING STATION (RADIO OR TV)
 - COMMUNICATION TOWER
- FARM UNITS, DWELLINGS, ETC.**
- FARM UNIT (FARM UNITS SHOWN IN MUNICIPAL LIMITS INDICATE FARM BUILDINGS FOR FARM USE)
 - DWELLING OTHER THAN FARM
 - ROWS OR GROUPS OF DWELLINGS CLOSELY SPACED (FIGURE DENOTES NUMBER OF DWELLINGS)
 - BARRACKS, OR DORMATORIES FOR STUDENTS, WORKERS, MIGRANTS, ETC.
 - SEASONAL OR SUMMER COLONY
 - DWELLING
 - SEASONAL DWELLINGS CLOSELY SPACED
 - HOTEL OR INN
 - CHURCH
 - CHURCH AND SCHOOL
 - CEMETERY
 - CHURCH WITH CEMETERY ADJACENT
 - TOLL HOUSE, STATE PORT OF ENTRY, OR WEIGHT STATION
- CONSERVATION AND RECREATION**
- PICNIC GROUND
 - PLAYGROUND, BALL FIELD, ETC.
 - BATHING BEACH OR SWIMMING POOL
 - SCENIC SITE
 - CAMP SITE, NO PERMANENCE (TENTS OR TRAILER PARKING)
 - TOURIST COURT, OR MOTEL
 - CAMP OR LODGE
 - SMALL PARK (SP-STATE, CP-COUNTY)
 - MP-MUNICIPAL, WP-WAYSIDE PARK
 - GOLF GROUND OR COUNTRY CLUB
 - AMUSEMENT PARK OR HALL
 - FAIR GROUND, RACE COURSE, SPEEDWAY
 - RIFLE CLUB
 - MARINA
 - DRIVE-IN THEATER
 - GUIDE HOUSE OR GATE HOUSE
- CITY AND VILLAGE CENTERS**
- COUNTY SEAT
 - OTHER CITIES AND VILLAGES
 - INCORPORATED CITY OR VILLAGE (GENERALIZED)
- MISCELLANEOUS**
- TRIANGULATION STATION
 - DOT TO INDICATE LOCATION OF ANY CULTURAL FEATURE SHOWN OUT OF POSITION
 - ALL VACANT CULTURE INDICATED BY OPEN SYMBOL
 - LATITUDE AND LONGITUDE

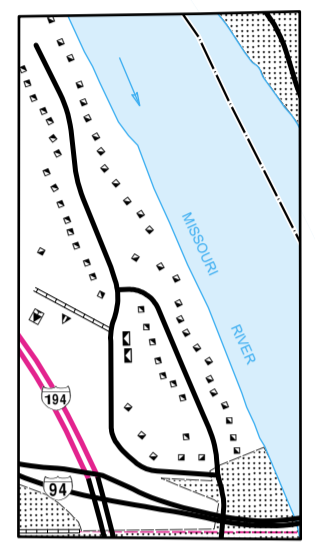
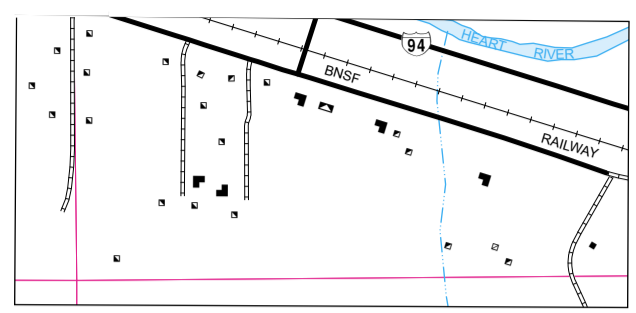
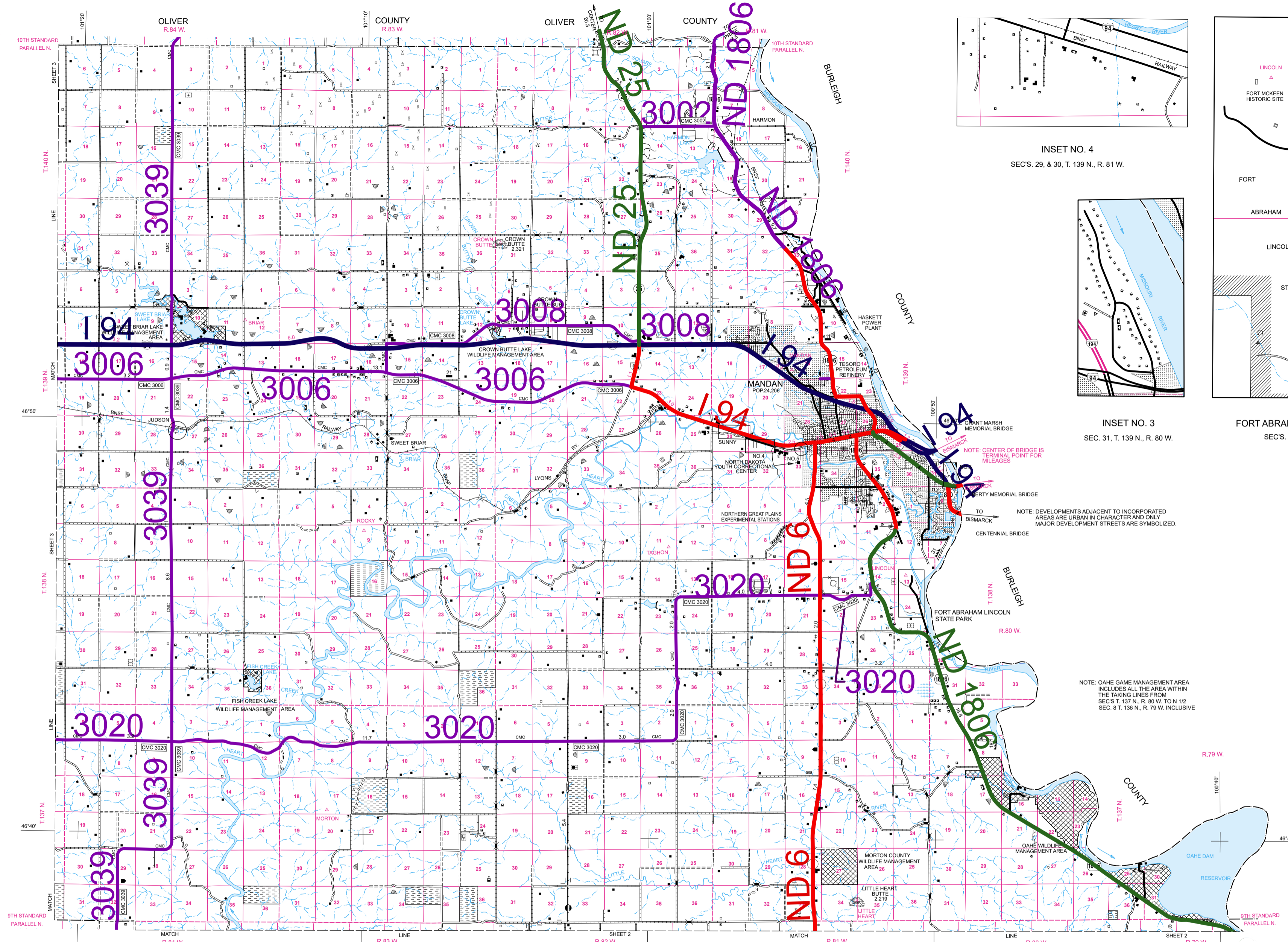
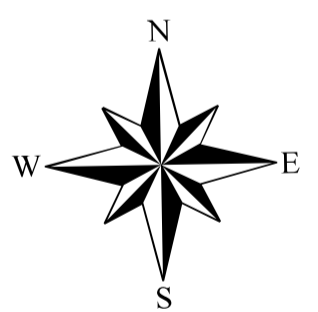

GENERAL HIGHWAY MAP MORTON COUNTY NORTH DAKOTA

PREPARED BY THE
NORTH DAKOTA DEPARTMENT OF TRANSPORTATION
PLANNING / ASSET MANAGEMENT DIVISION
IN COOPERATION WITH THE
U.S. DEPARTMENT OF TRANSPORTATION
FEDERAL HIGHWAY ADMINISTRATION

SCALE
1 0 1 2 3 4 Miles
0 0.25 0.5 Miles
SCALE FOR ENLARGEMENTS
1 0 1 2 3 4 5 Kilometers

2021

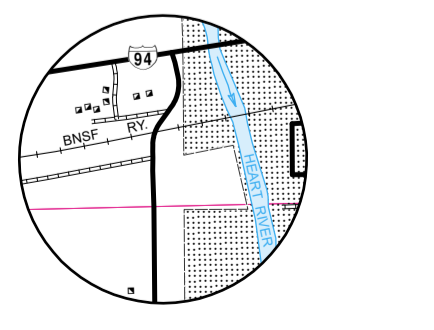
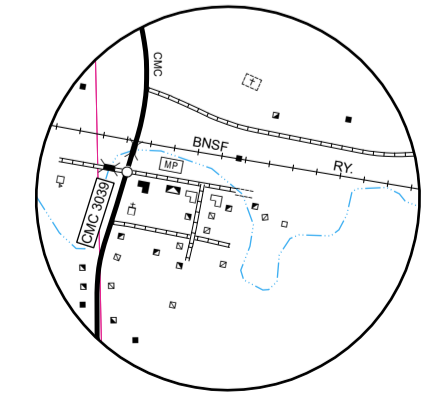
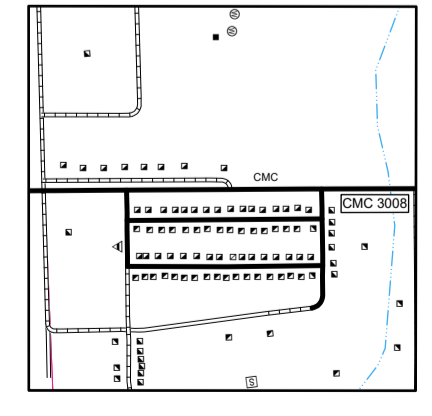
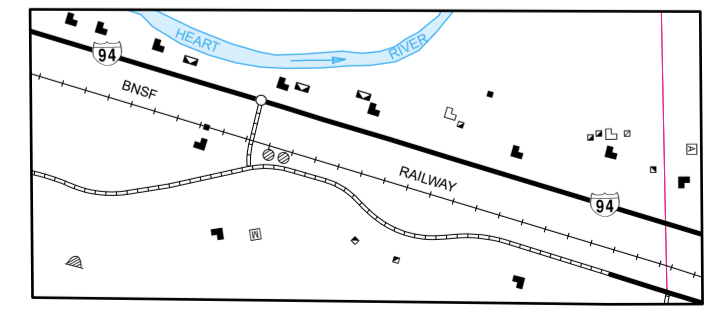
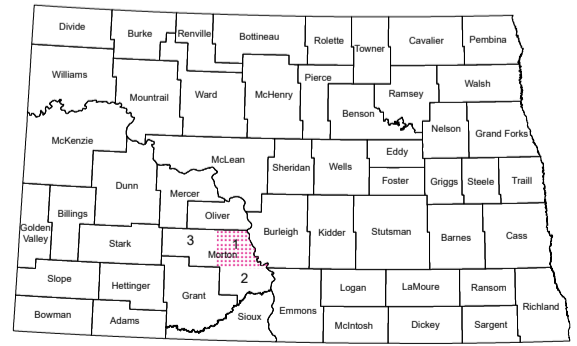

Notice of Disclaimer
The North Dakota Department of Transportation (NDDOT) makes this map available on an "as is" basis as a public service. Under no circumstances does NDDOT warrant or certify the information to be free of errors or deficiencies of any kind. NDDOT specifically disclaims all warranties, express or implied, including but not limited to the warranties of merchantability and fitness for a particular purpose.