

# 2007 FUNCTIONAL CLASSIFICATION

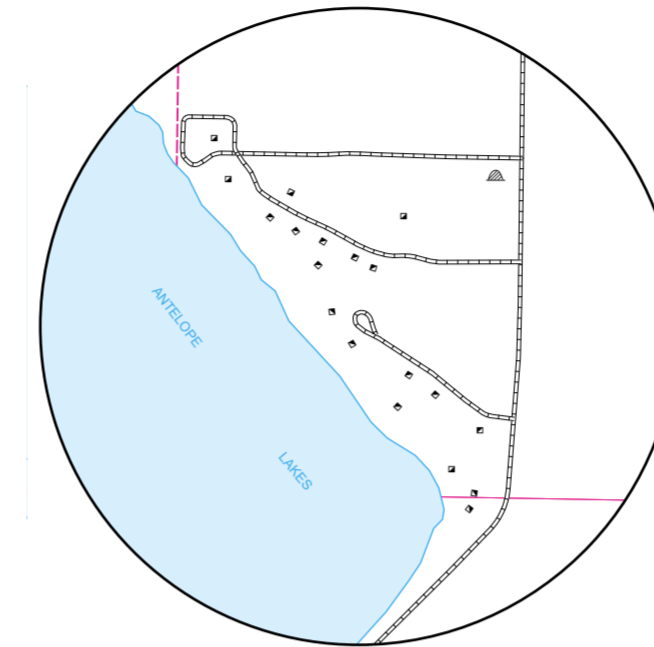

**ANTELOPE HILLS**  
SECS. 30 & 31, T. 152 N., R. 73 W.  
SECS. 25 & 36, T. 152 N., R. 74 W.

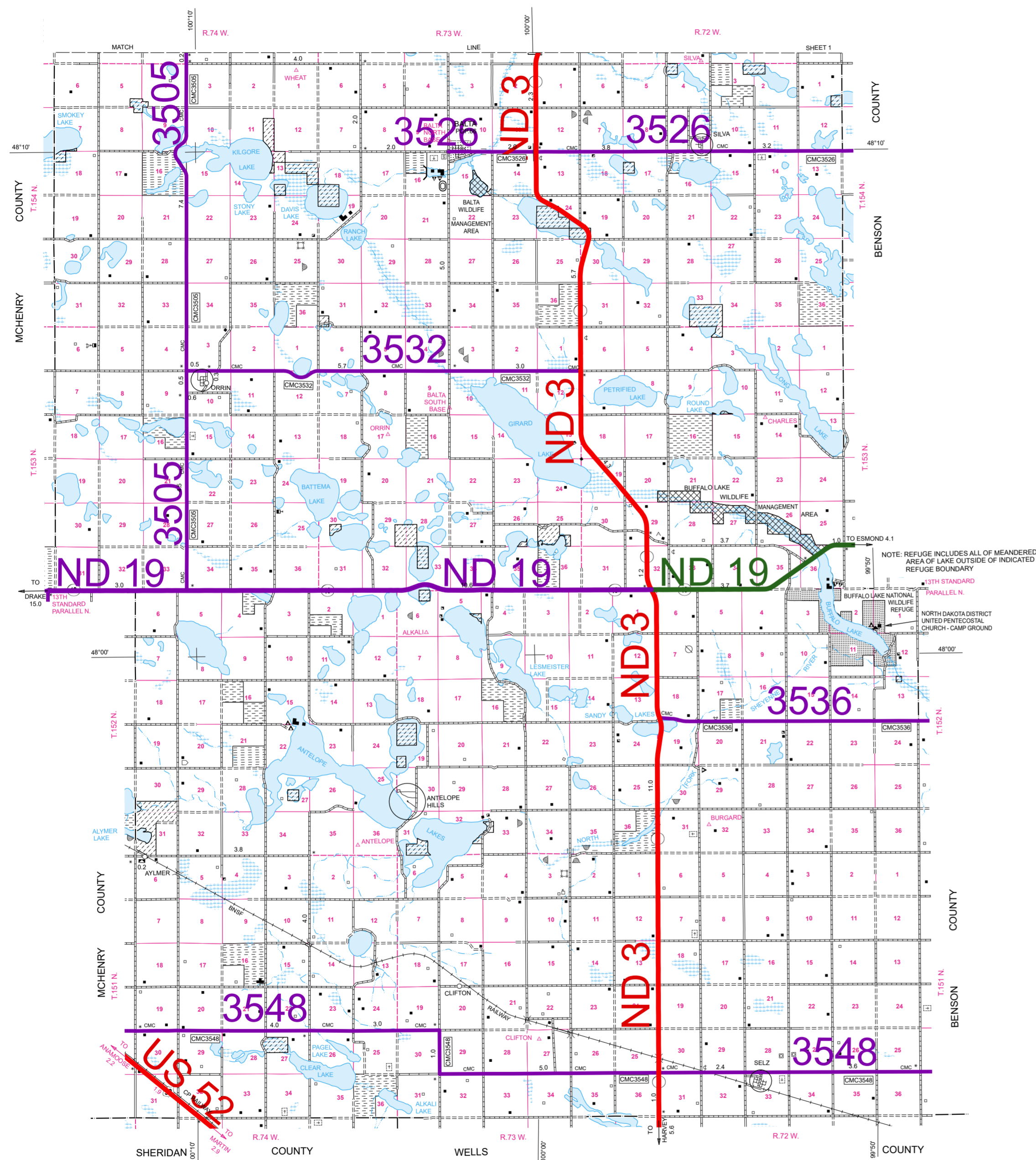
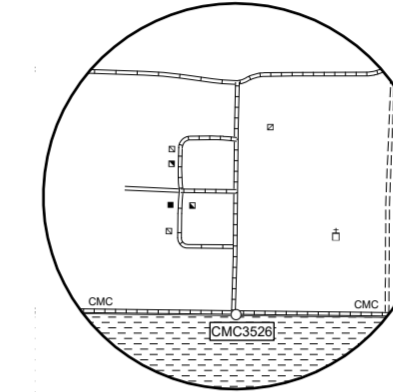

**SILVA**  
SECS. 9, 10, & 16, T. 154 N., R. 72 W.

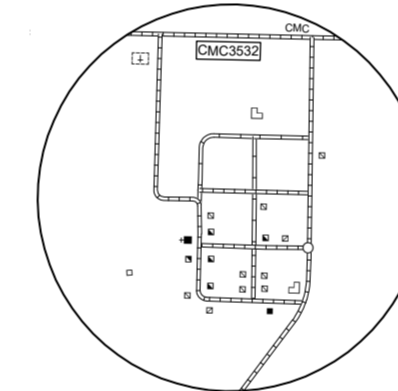

**ORRIN**  
SECS. 3 & 10, T. 153 N., R. 74 W.

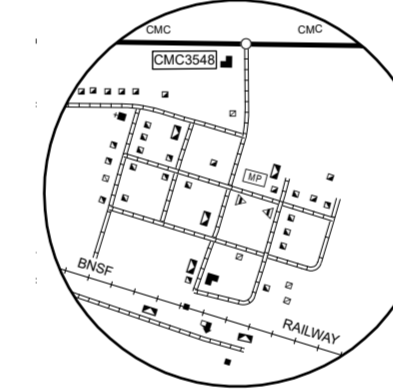

**SELZ**  
SECS. 28 & 33, T. 151 N., R. 72 W.

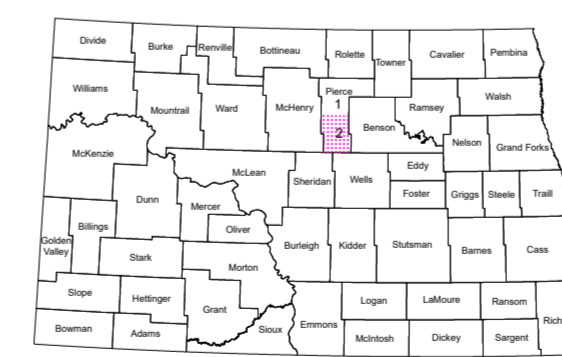

**STATE OF NORTH DAKOTA**  
DIAGRAM OF COUNTIES

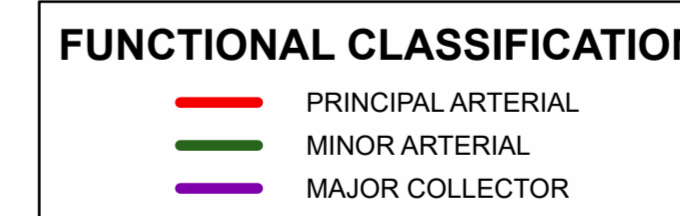

NAME AND LOCATION OF ORGANIZED CIVIL TOWNSHIPS THOSE UNORGANIZED ARE SO NOTED

- T. 158 N.-R. 74 W. UNORGANIZED
- T. 158 N.-R. 73 W. UNORGANIZED
- T. 158 N.-R. 72 W. UNORGANIZED
- T. 158 N.-R. 71 W. UNORGANIZED
- T. 158 N.-R. 70 W. UNORGANIZED
- T. 158 N.-R. 69 W. UNORGANIZED
- T. 157 N.-R. 74 W. UNORGANIZED
- T. 157 N.-R. 73 W. UNORGANIZED
- T. 157 N.-R. 72 W. TORGESEN
- T. 157 N.-R. 71 W. UNORGANIZED
- T. 157 N.-R. 70 W. RUSH LAKE
- T. 157 N.-R. 69 W. UNORGANIZED
- T. 156 N.-R. 74 W. NESS
- T. 156 N.-R. 73 W. UNORGANIZED
- T. 156 N.-R. 72 W. MEYER
- T. 155 N.-R. 74 W. JEFFERSON
- T. 155 N.-R. 73 W. TUSCARORA
- T. 155 N.-R. 72 W. RENO VALLEY
- T. 154 N.-R. 74 W. UNORGANIZED
- T. 154 N.-R. 73 W. BALTA
- T. 154 N.-R. 72 W. ELVERUM
- T. 153 N.-R. 74 W. ELLING
- T. 153 N.-R. 73 W. UNORGANIZED
- T. 153 N.-R. 72 W. UNORGANIZED
- T. 152 N.-R. 74 W. ANTELOPE LAKE
- T. 152 N.-R. 73 W. UNORGANIZED
- T. 152 N.-R. 72 W. ALEXANDER
- T. 151 N.-R. 74 W. WHITE
- T. 151 N.-R. 73 W. TRUMAN
- T. 151 N.-R. 72 W. HAGEL

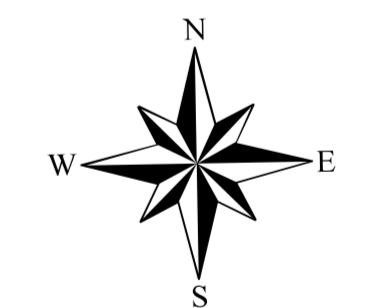

## GENERAL HIGHWAY MAP PIERCE COUNTY NORTH DAKOTA

PREPARED BY THE  
NORTH DAKOTA DEPARTMENT OF TRANSPORTATION  
PLANNING AND ASSET MANAGEMENT DIVISION

IN COOPERATION WITH THE  
U.S. DEPARTMENT OF TRANSPORTATION  
FEDERAL HIGHWAY ADMINISTRATION

SCALE  
1 0.5 0 1 2 3 4 Miles

SCALE FOR ENLARGEMENTS  
0 0.25 0.5 Miles

1 0.5 0 1 2 3 4 Kilometers

2021

BASED ON AERIAL PHOTOGRAPHY OF 1954 UNIVERSAL TRANSVERSE MERCATOR ZONE 14  
AERIAL INVENTORY OF 2021 NORTH AMERICAN DATUM 83

**Notice of Disclaimer**  
The North Dakota Department of Transportation (NDDOT) makes this map available on an "as is" basis as a public service. Under no circumstances does NDDOT warrant or certify the information to be free of errors or deficiencies of any kind. NDDOT specifically disclaims all warranties, express or implied, including but not limited to the warranties of merchantability and fitness for a particular purpose.

SHEET 2 OF 2