

MANDAN and BISMARCK

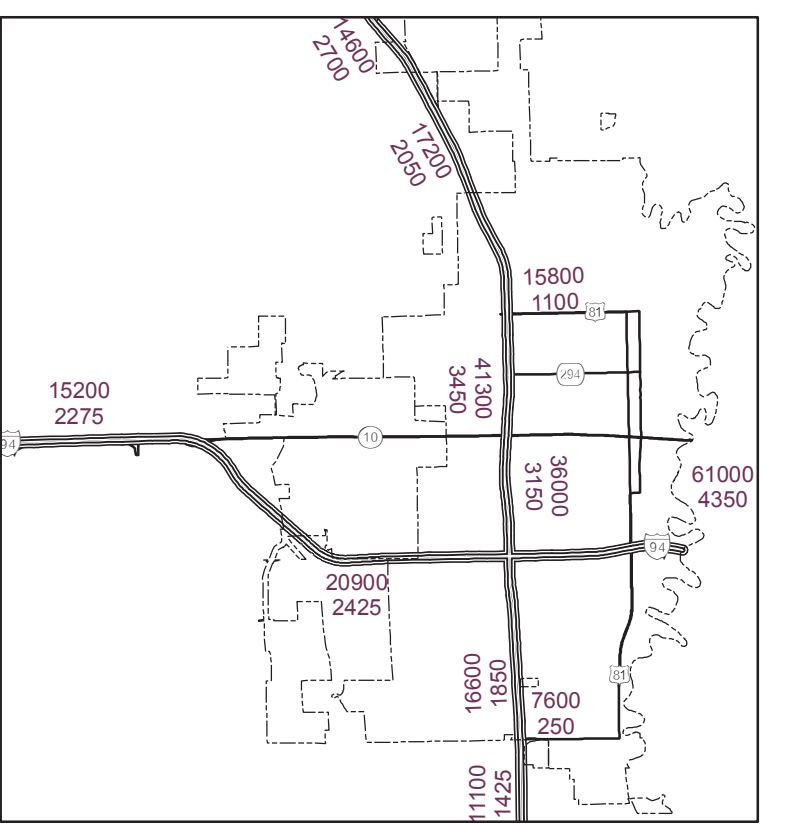

WEST FARGO and FARGO

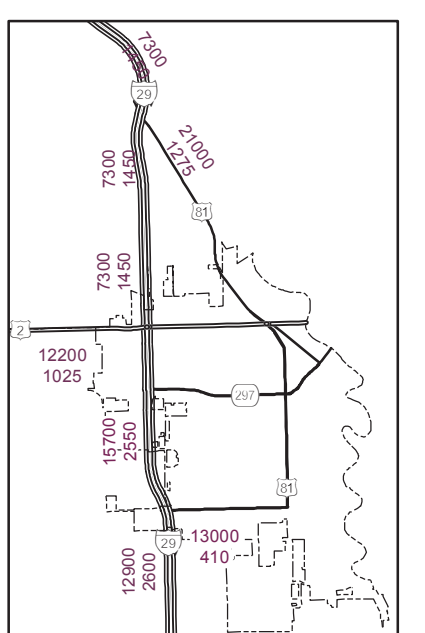

GRAND FORKS

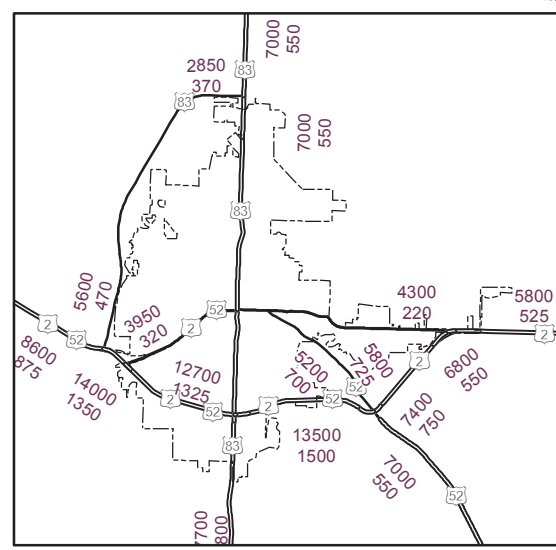

MINOT

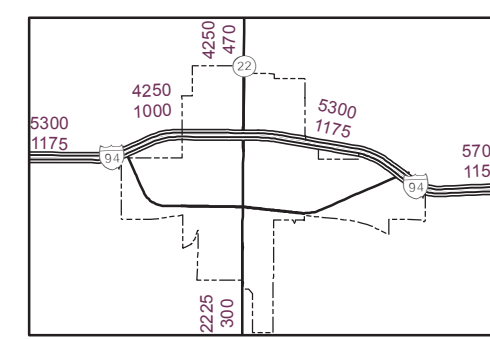

DICKINSON

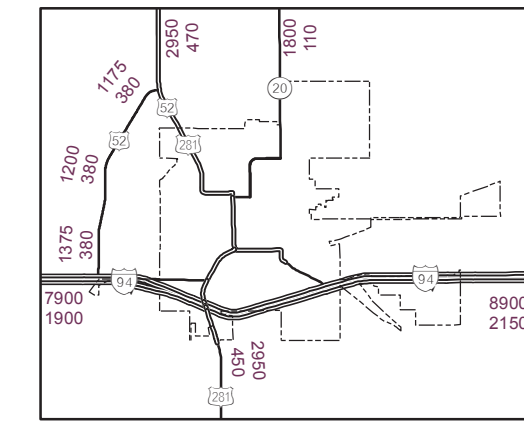

JAMESTOWN

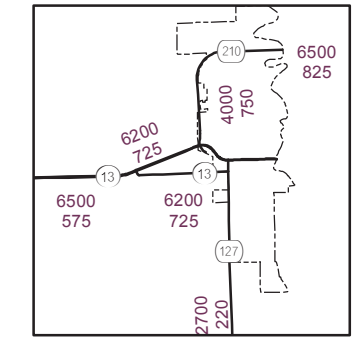

WAHPETON

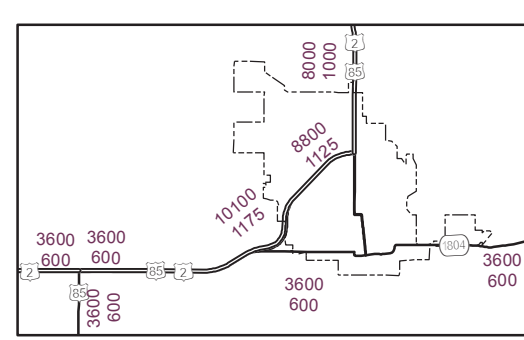

WILLISTON

**TRAFFIC LEGEND**

- AADT ( Average Annual Daily Traffic ) - 2500
- COMMERCIAL TRUCK TRAFFIC - 150
- THE TRAFFIC FIGURES ARE THE TOTAL AT THE CLOSEST HIGHWAY INTERSECTION OR TOWN.

- INTERSTATE NUMBERED HIGHWAY
- US NUMBERED HIGHWAY
- STATE NUMBERED HIGHWAY
- COUNTY LINE
- STATE CAPITAL \*

**2005 TRAFFIC VOLUME MAP STATE OF NORTH DAKOTA**

PREPARED BY THE  
NORTH DAKOTA DEPARTMENT OF TRANSPORTATION  
PLANNING & PROGRAMMING DIVISION  
IN COOPERATION WITH THE  
U.S. DEPARTMENT OF TRANSPORTATION  
FEDERAL HIGHWAY ADMINISTRATION

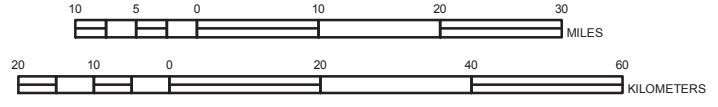

Copies of this map are available for public use at a nominal cost from:  
Map Sales, NDDOT, 608 E. Boulevard, Bismarck, ND 58505-0700.